

£530,000 EASTBOURNE ROAD , TW8 9PG



Property Details

TWO DOUBLE BEDROOMS
THROUGH LOUNGE
KITCHEN DINER
BATH/SHOWER
GARDEN

Aeon are pleased to offer new to market this two bedroom semi-detached house. Located on a residential turning offering easy access to local amenities. Property comprises of through lounge, two double bedrooms, bath/shower room. Benefits including gas central heating, double glazed, garden

Viewing via AEON CALL ON 02088140701, Property needs TLC.

Through Lounge 8.10m x 3.30m (26.57ft x 10.83ft)

Double Glazed Bay Window To Front, Radiator, Open Fire Place, Double Glazed Window To Right.

Kitchen/diner 5.60m x 2.90m (18.37ft x 9.51ft)

Double Glazed Window To Right And Side, Double Glazed Door To Garden, Single Drain Stainless Steel Sink With Mixer Taps, Eye and Base Level Kitchen Units, Plumbing For Washing Machine, Built in Oven Hob, Tiled Flooring.

Landing

Split Level Landing, Carpet, Access To Loft, Door to.

Bedroom One 4.50m x 3.70m (14.76ft x 12.14ft)

Double Glazed Window x2 Carpet, Radiator.

Bedroom Two 3.80m x 2.80m (12.47ft x 9.19ft)

Double Glazed Window, Carpet Radiator.

F/F Bathroom 3.20m x 2.90m (10.50ft x 9.51ft)

Double Glazed Window, Panel Enclosed Bath With Mixer Taps, Vanity Wash Hand Basin, Low Level W-C, Shower Cubicle, Tiled Floors, Heated Towel Rail.

Rear Garden

Mainly Laid To Lawn, Patio Area.





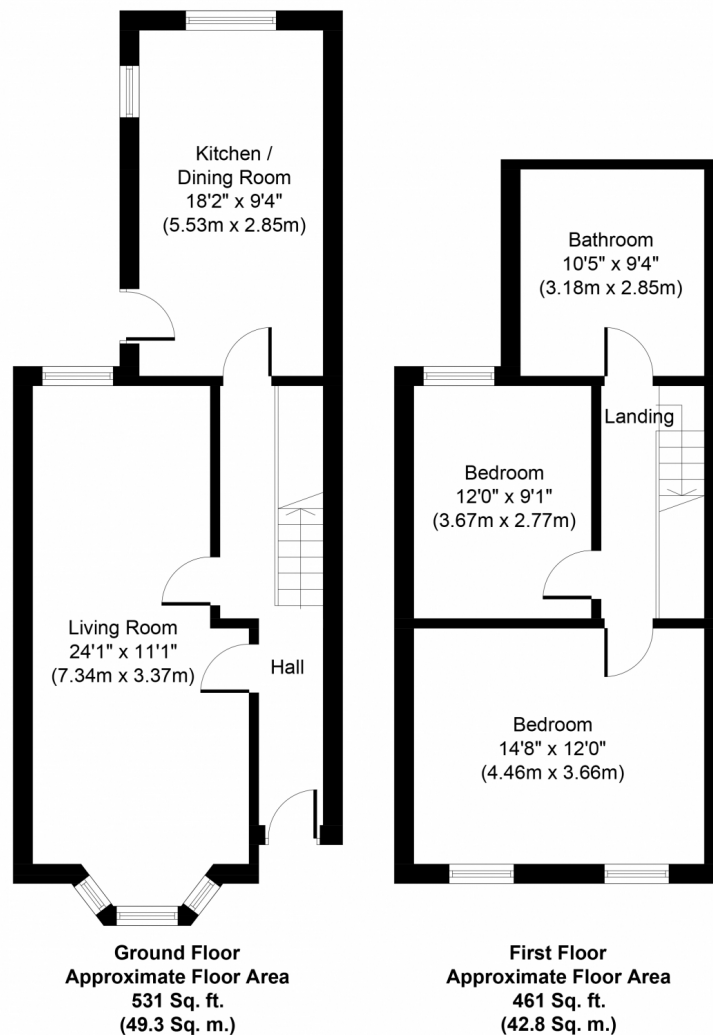

Whilst every attempt has been made to ensure the accuracy of the floor plan contained here, measurements of doors, windows, rooms and any other items are approximate and no responsibility is taken for any error, omission, or mis-statement. This plan is for illustrative purposes only and should be used as such by any prospective purchaser or tenant. The services, systems and appliances shown have not been tested and no guarantee as to their operability or efficiency can be given.

Copyright V360 Ltd 2020 | www.houseviz.com