



1

Bedroom



1

Bathroom



Situated in the Heart of Holborough Lakes this Wonderful Coach House will make the Perfect First Home or Investment Property.

Boasting an open plan living and kitchen area with integrated Bosch appliances, a perfect place for entertaining friends and family! The property also benefits a Juliet balcony.

The master bedroom is a fantastic size and benefits fitted wardrobes. The bathroom is a great size complete with shower over the bath.

There is a large hallway and a designated parking space for 1 car.

The Holborough Lakes development houses an on-site gym, village hall and crèche as well as a new primary school managed by the Valley Invicta Academies Trust (who are rated outstanding by Ofsted). The development is well located for both the M2 and M20 for easy access to the M25. Snodland train station now also benefits from High Speed Commuter trains to St Pancras inside 45 minutes (via Ebbsfleet and Stratford International).

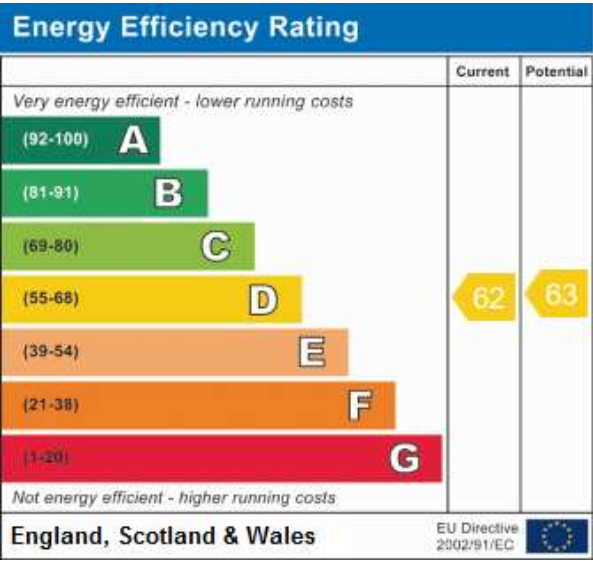

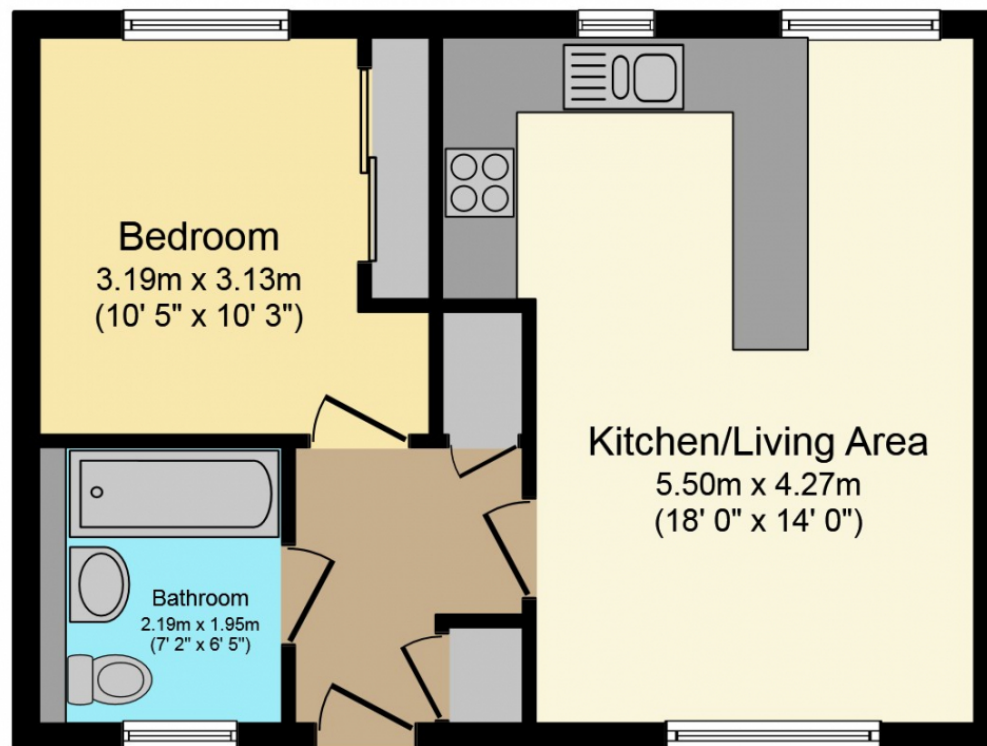

## First Floor

Floor area 41.4 sq. m. (445.8 sq. ft.) approx

Total floor area 41.0 sq. m. (441 sq. ft.) approx

This Floor Plan is for illustration purposes only and may not be representative of the property. The position and size of doors, windows and other features are approximate. Unauthorized reproduction prohibited. © PropertyBOX