



 **3**
Bedrooms

 **1**
Bathroom



Two double bedrooms! off road parking & garage! Located in the heart of Snodland, this three-bedroom property will suit many.

Located in Malling Road within the heart of the village, this three bedroom cottage is well placed with plenty of amenities right on your doorstep.

This property offers endless possibilities. With a cosy dining room as you enter the property! Leading through to a separate lounge, To the rear of the property you will find the kitchen, and conservatory which benefits a downstairs wc, overlooking the sunny low maintenance rear garden.

To the first floor you have a great sized master bedroom with plenty of room for all the usual bedroom furniture & En-suite, and a great sized second double bedroom with stairs leading upto the second bedroom with beautiful rooftop views across to the North Downs.

The sunny rear garden is a fantastic space to potter around leading onto the garage and parking space to the rear.

This house will be a great choice for first time buyers and small families alike!

Within the village there are supermarkets, post office, bakers, hairdressers, pharmacy, library, children's centre and tea rooms to name but a few.

Excellent transport links within walking distance. Snodland train station is a 5-minute walk away. This station has a direct service to London which takes 45 minutes. You will also have easy access to the M2 and the M20 motorways and a good bus service

You are a short distance from the beautiful Leybourne lakes country park which boasts great outdoor activities and is perfect for peaceful countryside walks for all of the family.

There are several picturesque villages within short journey times. Whilst Rochester is just across the river, with its host of pubs, bars and restaurants as well as the historic castle and cathedral.



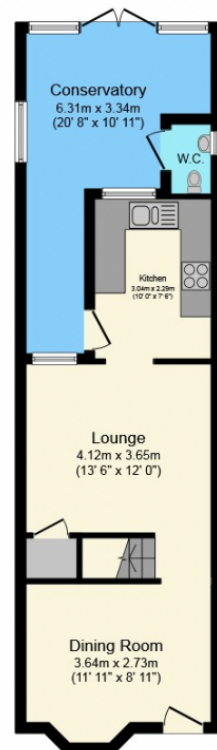

Ground Floor

Floor area 50.0 sq. m.
(538 sq. ft.) approx

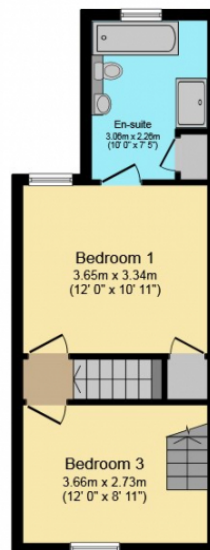

First Floor

Floor area 33.0 sq. m.
(355 sq. ft.) approx

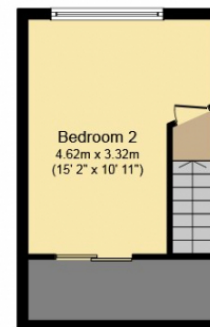

Loft Floor

Floor area 17.0 sq. m.
(183 sq. ft.) approx

Total floor area 100.0 sq. m. (1,076 sq. ft.) approx

This Floor Plan is for illustration purposes only and may not be representative of the property. The position and size of doors, windows and other features are approximate. Unauthorized reproduction prohibited. © PropertyBOX