



 **3**  
Bedrooms

 **2**  
Bathrooms







A chance to buy a beautiful **CHAIN FREE** 3 bedroom family home with lots of entertaining space! within walking distance to the ever popular Snodland CofE Primary School, train station & local shops, as well as Leybourne Lakes on your doorstep this could be the ideal location for many.

Park your car at ease on the driveway and come on in. The sellers have recently installed a new Kitchen complete with built in appliances, double oven & plate warmer, as well as plenty of space for a dining table - a perfect space for entertaining family and friends, the kitchen opens up onto a great sized lounge and extended family area with bi-fold doors, overlooking the garden giving you even more space for the family to spread out.

On the first floor you will find bedroom 1 which benefits plenty of wardrobe space and an en-suite, bedroom two is another great sized double with plenty of room for all the usual furniture and another built in wardrobe, whilst bedroom 3 also benefits built in storage & currently used as a home office/guest bedroom.

The garden is low maintainance & with astro turfed areas makes upkeep minimal. Everything has been done for you simply pack your bags and move in!

Snodland benefits from a good selection of local shops and services with a bus service into either Strood town centre, or West Malling. There is easy access to the A228 that leads through to both the M20 and M2, whilst the Snodland station has direct commuter trains to London. The nearby Medway Valley offers a large cinema, gym, 10 pin bowling and dining out. The nearby historic Rochester and West Malling both offer a great selection of pubs, bars and restaurants.

Call today to arrange your appointment to view

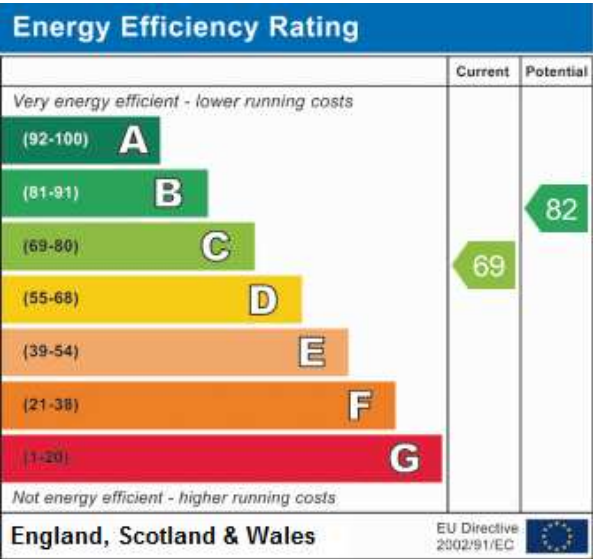

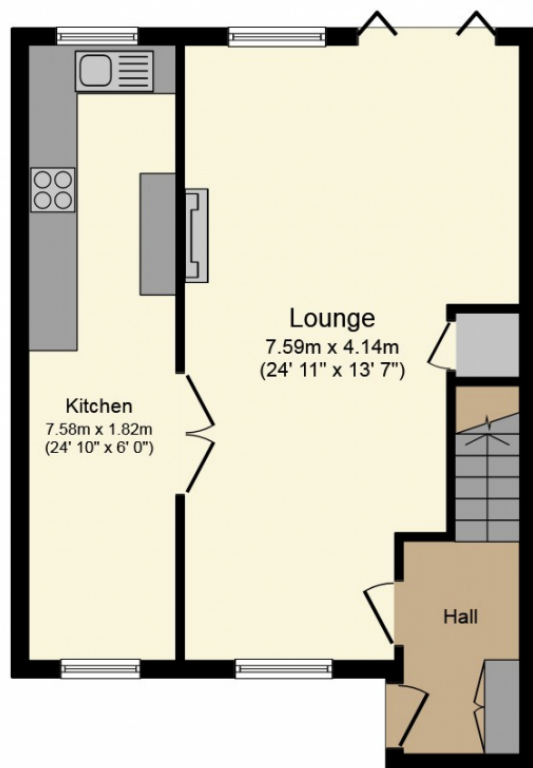

### Ground Floor

Floor area 48.0 sq. m. (517 sq. ft.) approx

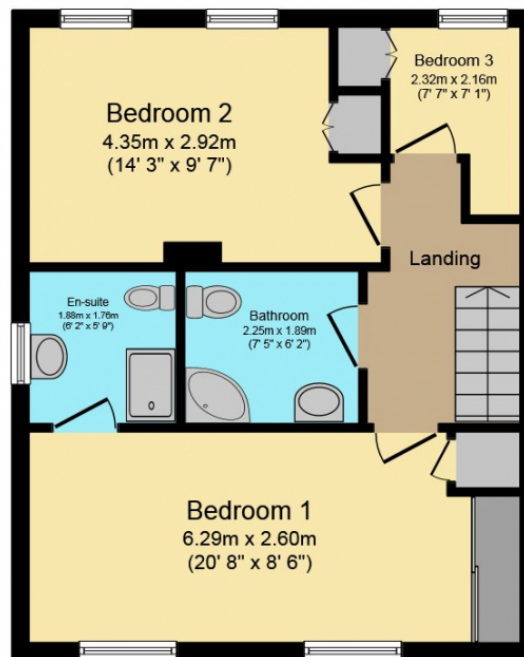

### First Floor

Floor area 46.0 sq. m. (495 sq. ft.) approx

Total floor area 94.0 sq. m. (1,012 sq. ft.) approx

This Floor Plan is for illustration purposes only and may not be representative of the property. The position and size of doors, windows and other features are approximate. Unauthorized reproduction prohibited. © PropertyBOX

