

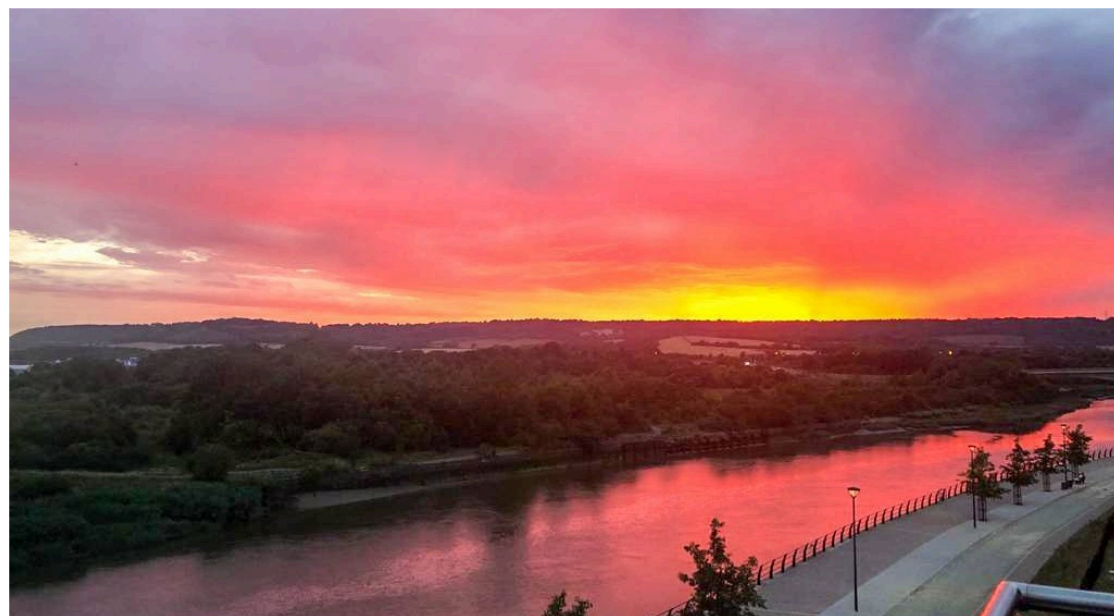

 4  
Bedrooms

 3  
Bathrooms







Imagine waking up to views like this every day! This property is one of a select few with a direct river view, benefitting a huge lounge backing onto the garden & a large modern kitchen/diner with integral appliances as well as a balcony to the master bedroom with a direct river view

To the first floor you will find the master bedroom which is a fantastic size with plenty of room for all the usual bedroom furniture and benefits a balcony as well as an en-suite, Bedroom two is another big double overlooking the rear garden & is located next to the family bathroom.

On the top floor Bedroom 3 (another double) has access to the shower room which can also be accessed from the landing. Bedroom 4 is yet another double - so there will be no arguments over bedroom sizes in this property.

The low maintenance garden is mainly astro turfed but benefits a great sized patio as well as side access.

This property benefits from; downstairs Wc, ample storage, two allocated parking spaces (with your own car port & **Electric Vehicle Charging Point!**), gas central heating and stunning river views to the dining area & kitchen as well as bedrooms 1 & 3. And 7 years remaining on the NHBC

Peters Village is a very sought after development set beside Peter's Bridge for direct routes over the Medway. Wouldham village lies just a mile away for local services. The M2 junction is less than 5 miles away and Snodland Station with fast routes into London is just 2.4 miles away.

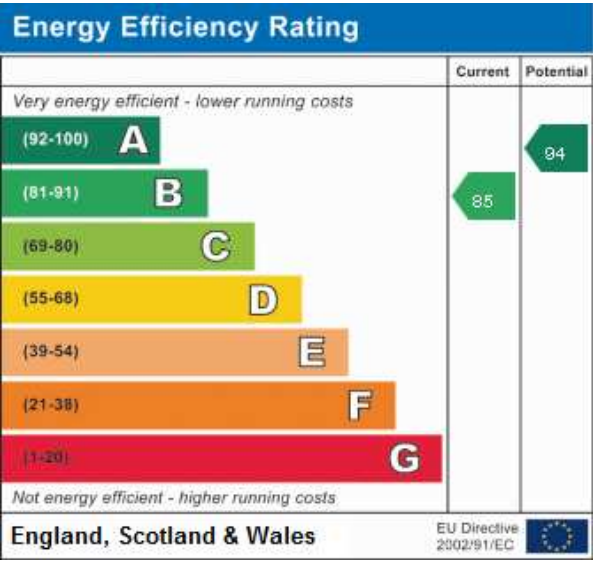

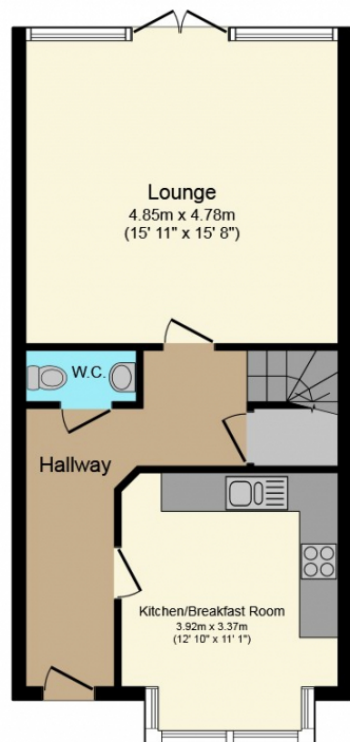

**Ground Floor**

Floor area 50.0 sq. m. (538 sq. ft.)  
approx

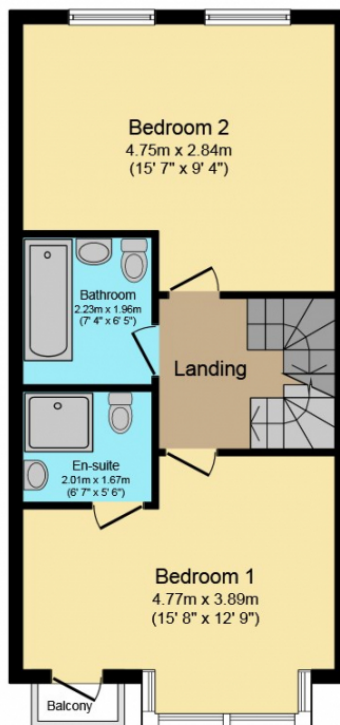

**First Floor**

Floor area 50.0 sq. m. (538 sq. ft.)  
approx

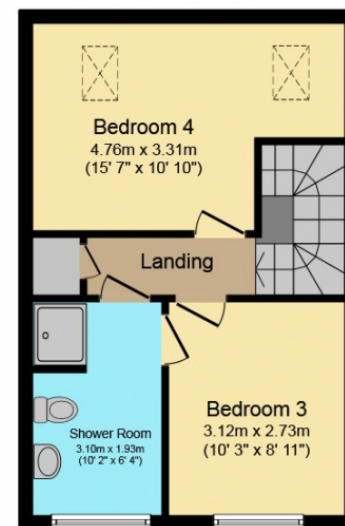

**Second Floor**

Floor area 37.0 sq. m. (398 sq. ft.)  
approx

**Total floor area 137.0 sq. m. (1,475 sq. ft.) approx**

This Floor Plan is for illustration purposes only and may not be representative of the property. The position and size of doors, windows and other features are approximate. Unauthorized reproduction prohibited. © PropertyBOX