 1
Bedroom

 2
Bathrooms



This spacious Coach House apartment is located in the sought after location of Holborough Lakes!

The property comprises a huge master bedroom with En Suite, lots of storage and a built in wardrobe.

The living area is perfect for entertaining as its open plan with access to the immaculate kitchen with built in appliances, and a Juliette balcony perfect for a summer evening!

The property benefits from a Wc as well as a private garage - large enough to park in.

The Holborough Lakes development benefits from vast landscaped areas including waterside pathways, mature trees and lakes all with the backdrop of the North Downs.

For the active out there, there is an on-site gym, activity trail and swimming club on site. The development is well located for both the M20 and M2 for easy access to the M25. Rail connections are provided at the nearby Snodland railway station with its fast service into London. For those who like shopping, Bluewater is just over 20 minutes via car, whilst the historic towns of Rochester and Maidstone can be reached in around 15 minutes by car, both providing the services you would expect from significant towns.



Leasehold	125 years from 2005
Service Charge	Approx £500 half yearly
Ground Rent	£250 pa
Council Tax Band	B

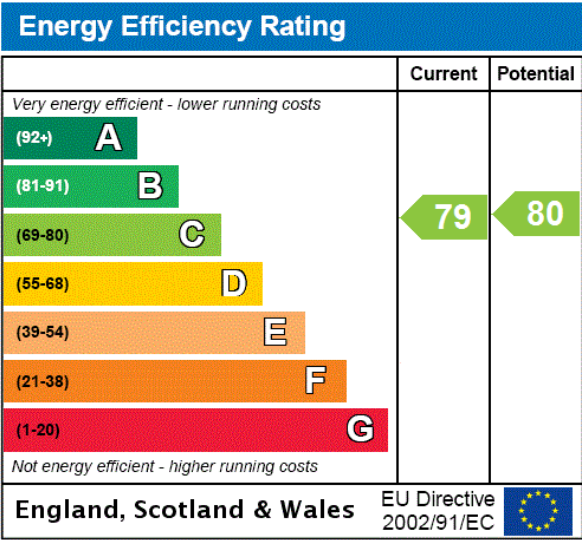

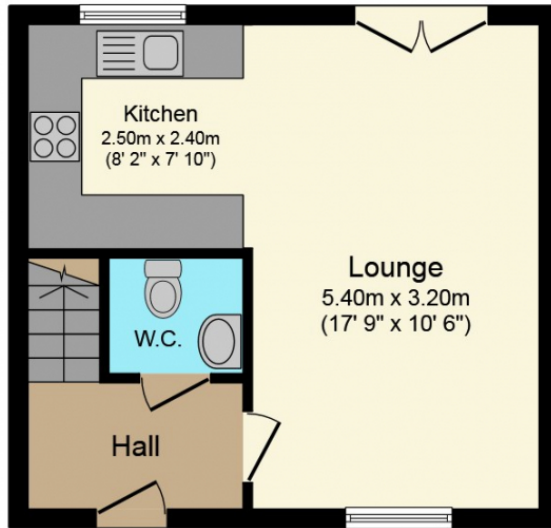

Ground Floor

Floor area 30.8 sq.m. (331 sq.ft.) approx

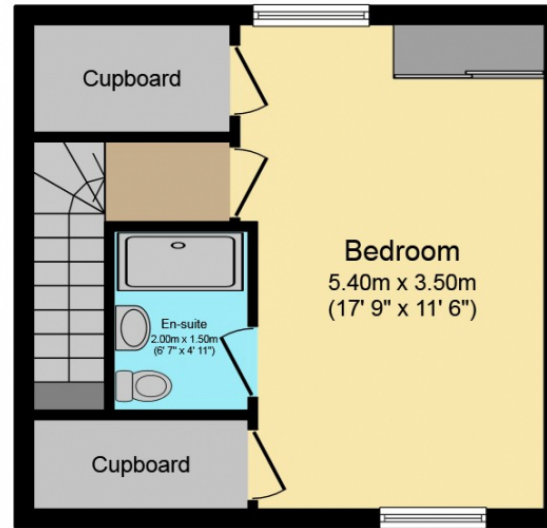

First Floor

Floor area 30.8 sq.m. (331 sq.ft.) approx

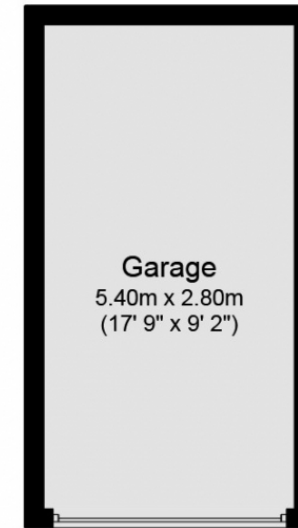

Garage

Floor area 15.1 sq.m. (163 sq.ft.) approx

Total floor area 76.5 sq.m. (823 sq.ft.) approx

This Floor Plan is for illustration purposes only and may not be representative of the property. The position and size of doors, windows and other features are approximate. Unauthorized reproduction prohibited. © PropertyBOX