



 **3**
Bedrooms

 **1**
Bathroom



A chance to buy a beautiful 3 bedroom family home finished to a beautiful standard throughout, just pack your bags and move in! within walking distance to the ever popular Snodland CofE Primary School, train station & local shops, as well as Leybourne Lakes & the north downs on your doorstep this could be the ideal location for many.

If you are looking for a large modern kitchen then this will be sure to impress with plenty of worktop space & room for a dining table, The lounge is a fantastic size with plenty of space for all your furniture & benefits air conditioning, opening up onto a large conservatory (with under floor heating) over looking the beautiful low maintenance rear garden - a perfect space for entertaining family and friends!

Upstairs, Bedroom 1 is a great size with heaps of space for all your bedroom furniture again benefiting air conditioning, Bedroom 2 is a good sized double with built in storage and air conditiong, whilst bedroom 3 is a larger than average bedroom offering lots of space. The family shower room is fitted to a fantastic standard.

With the added benefit of a downstairs Wc, ample storage and not work to do - This is a property you will not want to miss!

Snodland benefits from a good selection of local shops and services with a bus service into either Strood town centre, or West Malling. There is easy access to the A228 that leads through to both the M20 and M2, whilst the Snodland station has direct commuter trains to London. The nearby Medway Valley offers a large cinema, gym, 10 pin bowling and dining out. The nearby historic Rochester and West Malling both offer a great selection of pubs, bars and restaurants.

Call today to arrange your appointment to view

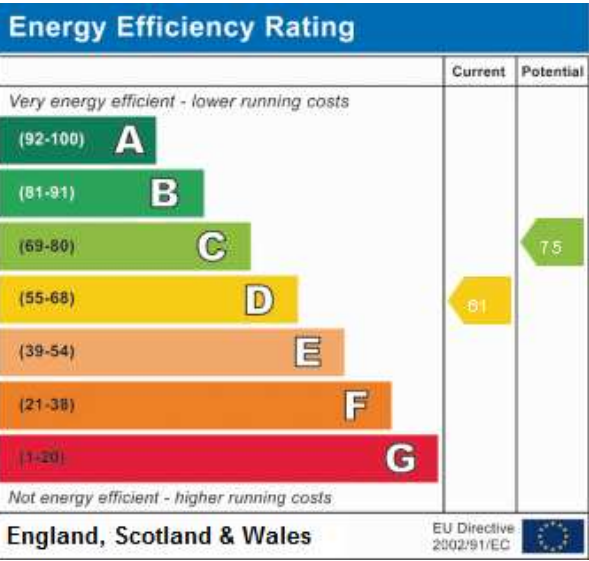

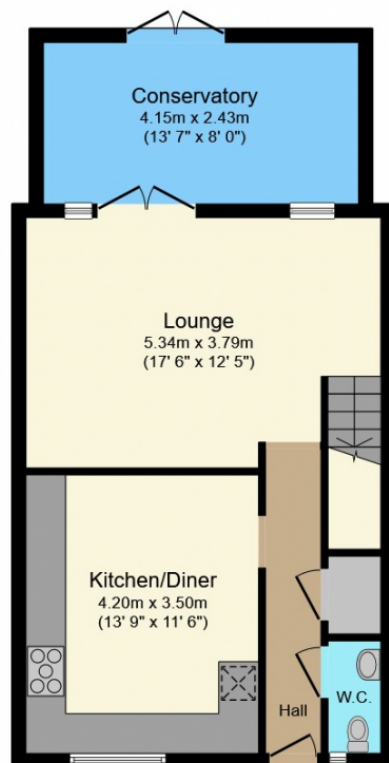

Ground Floor

Floor area 55.6 sq.m. (598 sq.ft.)
approx

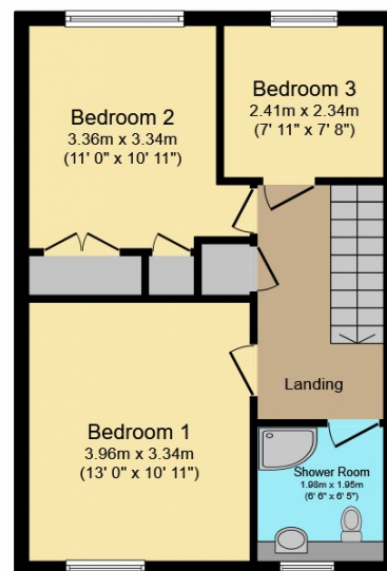

First Floor

Floor area 43.1 sq.m. (464 sq.ft.)
approx

Total floor area 98.6 sq.m. (1,062 sq.ft.) approx

This Floor Plan is for illustration purposes only and may not be representative of the property. The position and size of doors, windows and other features are approximate. Unauthorized reproduction prohibited. © PropertyBOX