



3

Bedrooms



1

Bathroom

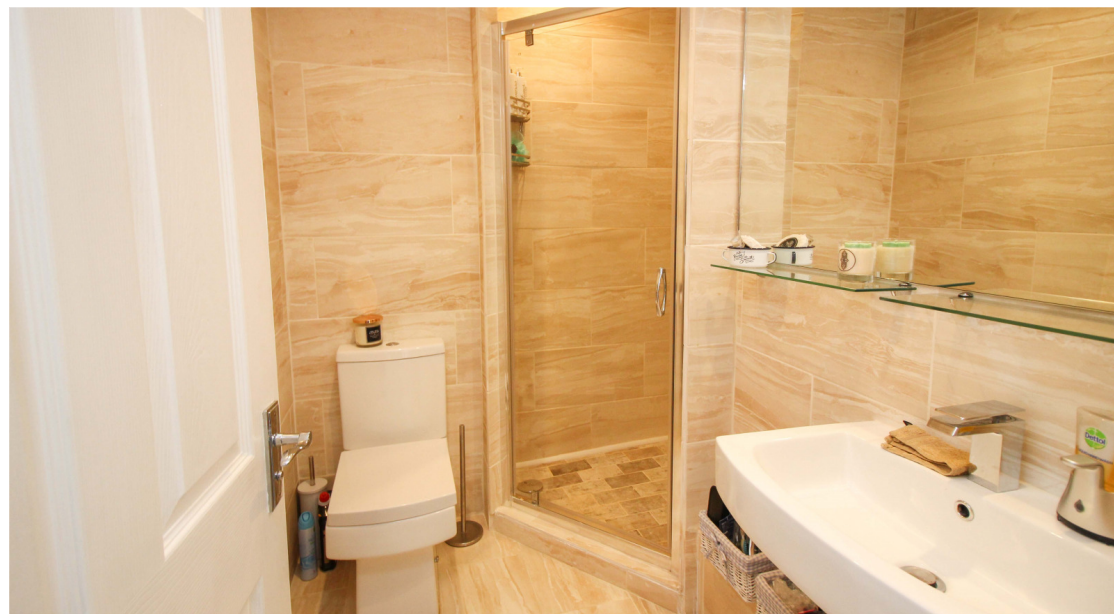

What The Agent Says! This stunning home has been completely renovated from top to bottom to a very high standard. Still oozing with character and charm, you can move straight in and take advantage of the improvements that have been carried out by the current owners. Set in the village centre and close proximity to all the local amenities. Whether its transport links, like the high-speed train into London, schools & the local shops and pubs are all close by.

Kick off your coat and shoes in the porch and come on in! Once inside the home an impressive cosy lounge welcomes you with its light and airy feel, a separate dining room makes a perfect setting for entertaining friends and family, opening onto a great sized newly fitted modern Kitchen with lots of worktop space. With an original beam kept as a beautiful feature housing the kitchen lights! Downstairs you will also find a very handy Wc & utility room!

To the first floor you will find a great sized master bedroom complete with fitted wardrobes, the third bedroom currently used as a home office is larger than most 3rd bedrooms offering plenty of space for all the usual bedroom furniture.

The second floor you will find a beautiful second double bedroom with views across the North Downs.

The landscaped garden offers minimal maintenance, a large patio area and decked area makes the perfect space for summer BBQ's to entertain family & friends - to the rear of the garden you will find a huge cabin with bundles of storage & best of all a home bar complete with serving hatch.

Council Tax Band	C
------------------	---

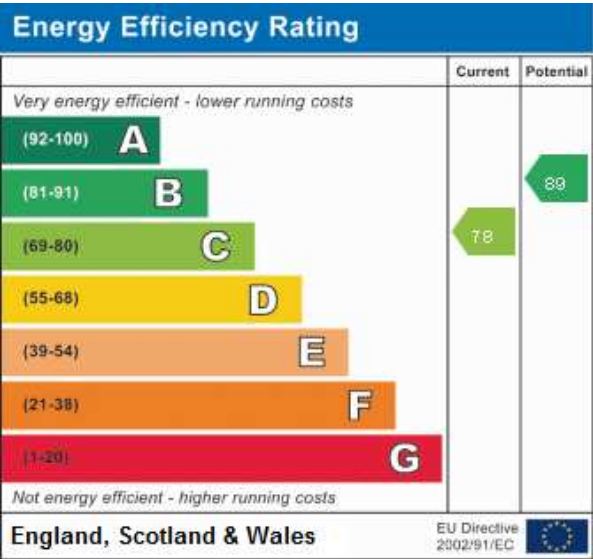

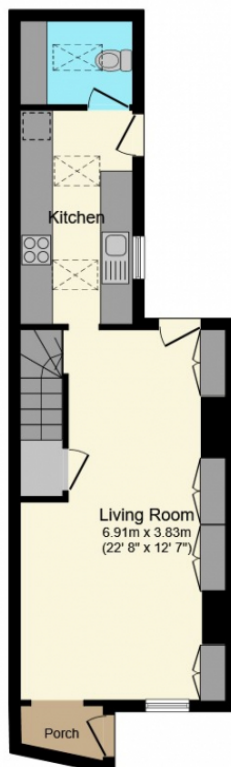

Ground Floor

Floor area 40.0 sq.m.
(431 sq.ft.) approx



First Floor

Floor area 26.5 sq.m.
(285 sq.ft.) approx

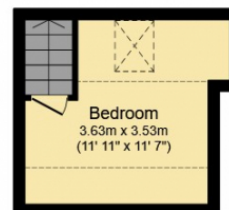

Top Floor

Floor area 12.2 sq.m.
(132 sq.ft.) approx

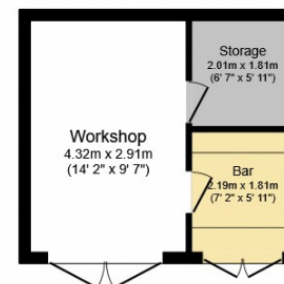

Garage

Floor area 7.8 sq.m. (84
sq.ft.) approx

Total floor area 86.6 sq.m. (932 sq.ft.) approx

This Floor Plan is for illustration purposes only and may not be representative of the property. The position and size of doors, windows and other features are approximate. Unauthorized reproduction prohibited. © PropertyBOX