



 4
Bedrooms

 2
Bathrooms



*** WHAT THE OWNER LOVES ***

I have loved the proximity to the shops and town and the space the house has to offer, I have been able to adapt the space to my family's needs, I really enjoy the garden and have the sun from 1pm until it sets, having the extra parking has also been a huge bonus.

*** THE PROPERTY ***

A BEAUTIFUL 4 BEDROOM DETACHED home in a FANTASTIC LOCATION and a selection of local shops on your doorstep. With GREAT SIZED BEDROOMS on offer and PLENTY OF LIVING SPACE available, this home would suit many!

As you enter the home, you are greeted with a LARGE HALLWAY and a handy DOWNSTAIRS WC! The hallway leads through to a LARGE/LOUNGE/DINER, the current owner has created ANOTHER BEDROOM WITH EN-SUITE to the ground floor

The MODERN KITCHEN is a GREAT SIZE and offers PLENTY OF STORAGE. The garden can be accessed via the dining area or the downstairs en-suite and is a GREAT SIZE with a nice DECKED AREA to soak up the sun & let the kids run riot.

The first floor offers a second DOUBLE BEDROOM and a FANTASTIC SIZED THIRD BEDROOM, the LARGE BATHROOM is in GREAT CONDITION and offers a shower over the bath. You will also find the LARGE MASTER BEDROOM offering PLENTY OF ROOM for wardrobes and other bedroom furniture!

You are a stone's throw away from the local convenience stores, the local school St James the Great Academy is just around the corner which will make getting the kids to school on time a breeze! The Malling Secondary School is also within close proximity, there is also a great bus service into Maidstone and surrounding areas at the end of the road.

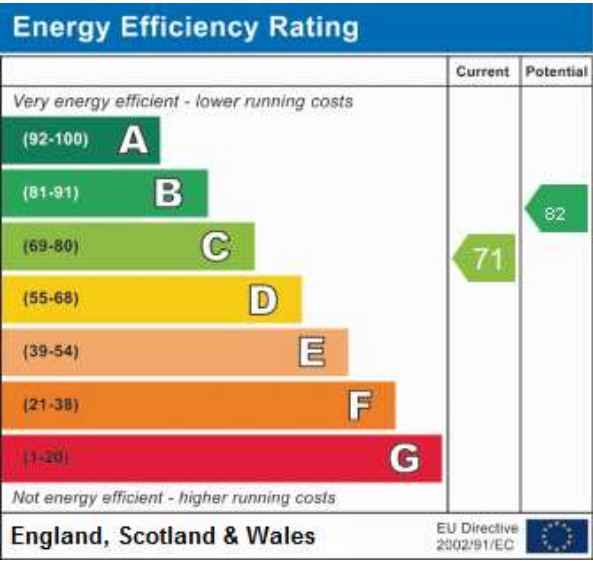



Ground Floor
Floor area 84.7 sq.m. (912 sq.ft.) approx

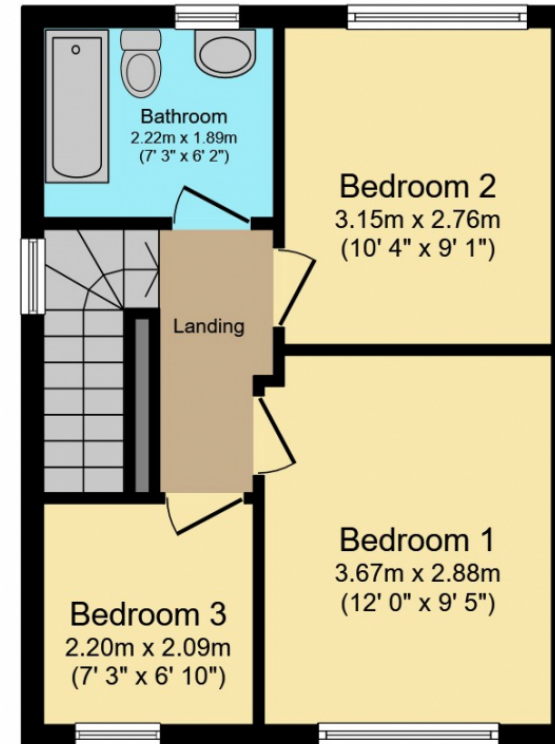

First Floor
Floor area 34.9 sq.m. (376 sq.ft.) approx

Total floor area 119.7 sq.m. (1,288 sq.ft.) approx

This Floor Plan is for illustration purposes only and may not be representative of the property. The position and size of doors, windows and other features are approximate. Unauthorized reproduction prohibited. © PropertyBOX