

Ground Floor

Approx. 44.9 sq. metres (483.6 sq. feet)

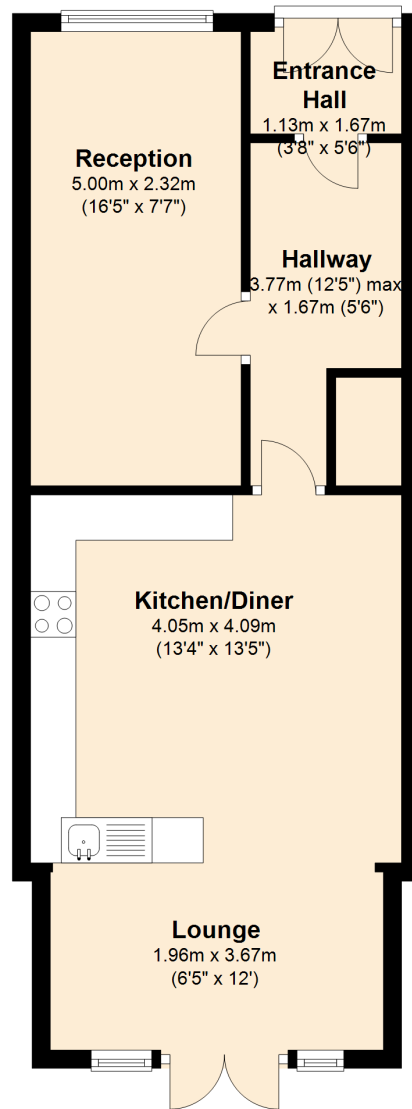

First Floor

Approx. 35.0 sq. metres (376.3 sq. feet)

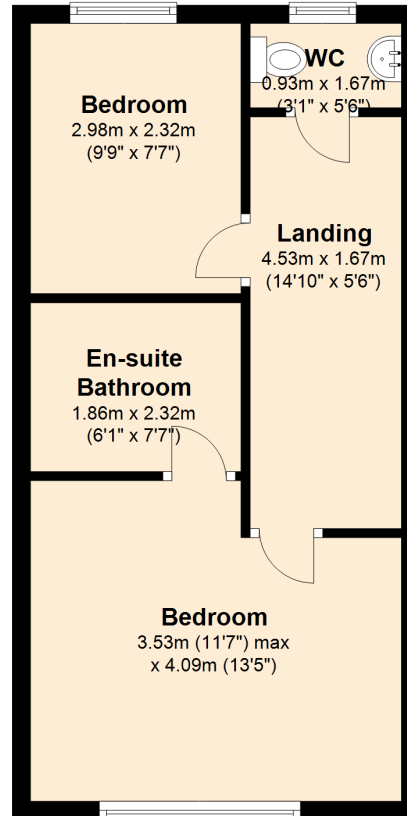

Second Floor

Approx. 34.8 sq. metres (374.7 sq. feet)

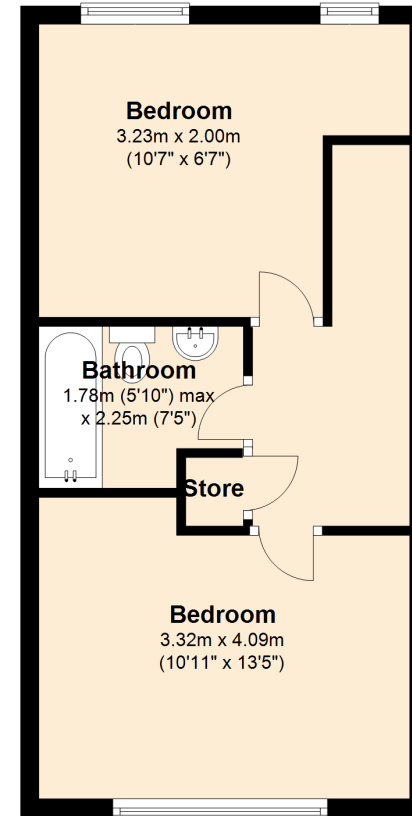

Total area: approx. 114.7 sq. metres (1234.7 sq. feet)

Not to scale

Plan produced using PlanUp.

4 Aplin Way, Isleworth