



 1
Bedroom

 1
Bathroom



Located within the Wembley/Perivale borders is this well present and looked after One Bedroom First Floor Flat. Internally you will find a spacious lounge, separate kitchen, Bedroom with fitted wardrobes and family bathroom. Externally you will find the property benefits from an allocated parking space, no chain and a lease of over 100 years. All in all, this would make an ideal first time or investment purchase and viewing is highly recommended.

FIRST FLOOR
313 sq.ft. (29.1 sq.m.) approx.

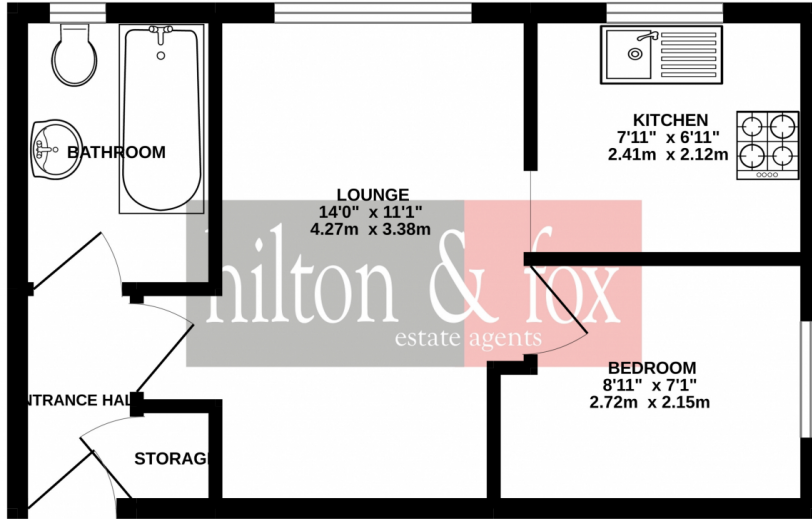

TOTAL FLOOR AREA: 313 sq.ft. (29.1 sq.m.) approx.
Whilst every attempt has been made to ensure the accuracy of the floorplan contained here, measurements of doors, windows, rooms and any other items are approximate and no responsibility is taken for any error, omission or mis-statement. This plan is for illustrative purposes only and should be used as such by any prospective purchaser. The services, systems and appliances shown have not been tested and no guarantee as to their operability or efficiency can be given.
Made with Metropix ©2022

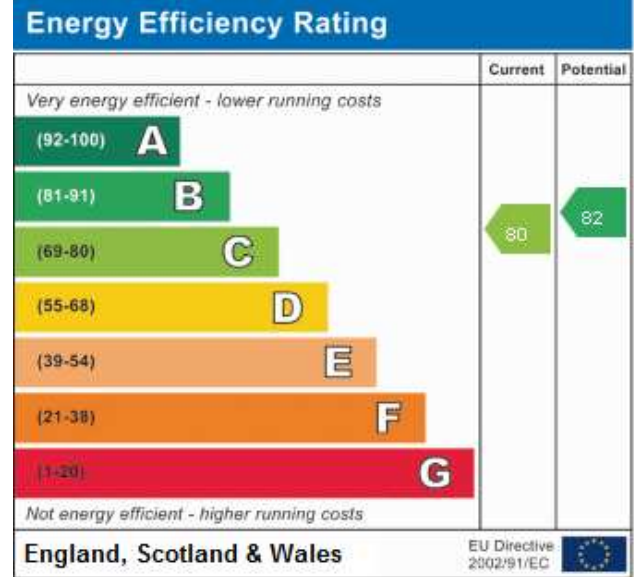

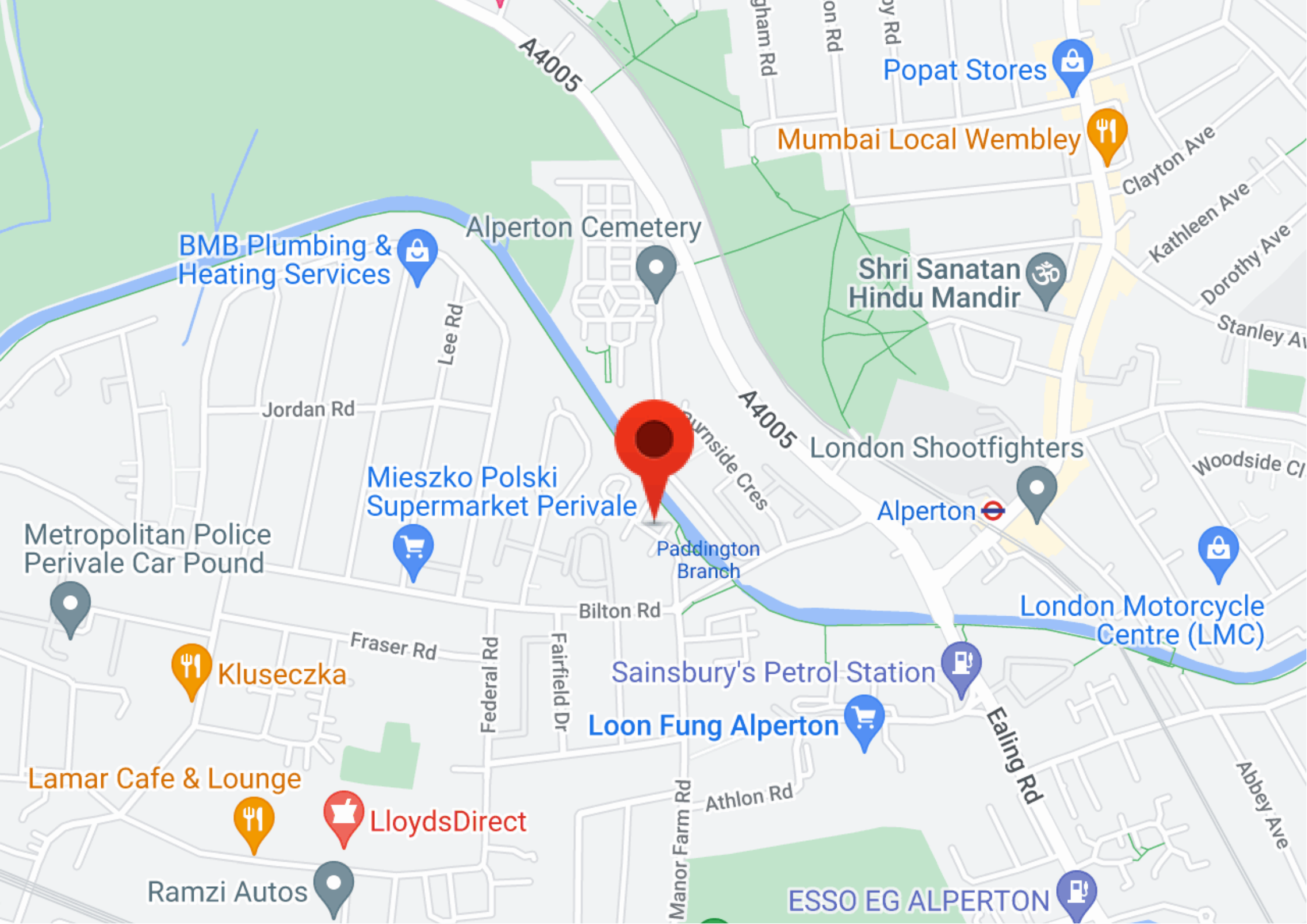

BMB Plumbing & Heating Services

Alperton Cemetery

Popat Stores

Mumbai Local Wembley

Shri Sanatan Hindu Mandir

Jordan Rd

Mieszko Polski Supermarket Perivale

London Shootfighters

Metropolitan Police Perivale Car Pound

Alperton



Paddington Branch



London Motorcycle Centre (LMC)

Kluseczka

Sainsbury's Petrol Station

Lamar Cafe & Lounge

Loon Fung Alperton



LloydsDirect

Ramzi Autos

ESSO EG ALPERTON

A4005

A4005

Clayton Ave
Kathleen Ave
Dorothy Ave
Stanley Ave

Woodside Cres

Fraser Rd

Federal Rd

Fairfield Dr

Bilton Rd

Manor Farm Rd

Athlon Rd

Ealing Rd

Abbey Ave