



2

Bedrooms



1

Bathroom



Benefitting from off street parking, private garden and a long lease is this Two Double Bedrooms ground floor maisonette. Internally the property is presented in good condition and been cared for by the current landlord and tenants. Externally you will find the property is ideally placed giving you easy access to Sudbury Town and its range of shops and transport links. All in all, this is one not to be missed.

GROUND FLOOR
500 sq.ft. (46.5 sq.m.) approx.

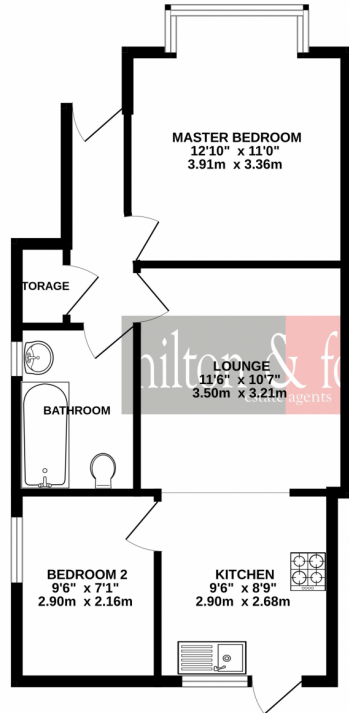

TOTAL FLOOR AREA: 500 sq.ft. (46.5 sq.m.) approx.

Whilst every attempt has been made to ensure the accuracy of the floorplan contained here, measurements of doors, windows, rooms and any other items are approximate and no responsibility is taken for any error, omission or mis-statement. This plan is for illustrative purposes only and should be used as such by any prospective purchaser. The services, systems and appliances shown have not been tested and no guarantee as to their operability or efficiency can be given.
Made with floorplan 100221

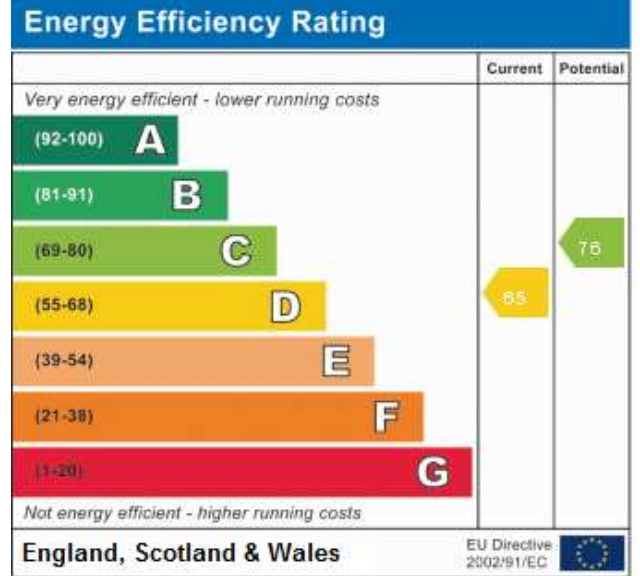



Tesco Express

Vale Farm Sports Centre

Shree Jalaram Jyot Mandir

Partyman World of Play

Himalayan

LNER Sports and Social Club

The Aura

Sudbury & Harrow Road

Tesco Express

Sundarban Tandoori

Sudbury Town

Barham Park

Wembley Police Station

Wembley