



3

Bedrooms



1

Bathroom



Hilton & fox are pleased to offer to the market this 3 bedroom terrace family home.

To the ground floor you will find a through lounge, a fitted kitchen and access to a private rear garden.

The first floor comprises of the three bedrooms with a family bathroom. Off street parking is available for a car.

Being on Locket road, you also have transport links into Harrow, Edgware and many other destinations.

Call now to arrange a viewing!

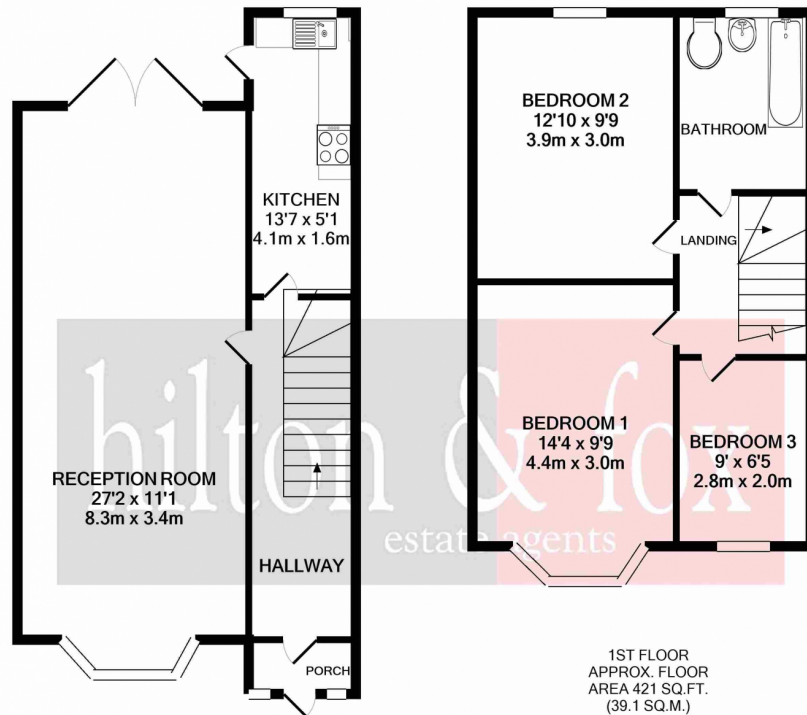

GROUND FLOOR
APPROX. FLOOR
AREA 457 SQ.FT.
(42.5 SQ.M.)

TOTAL APPROX. FLOOR AREA 878 SQ.FT. (81.5 SQ.M.)

Whilst every attempt has been made to ensure the accuracy of the floor plan contained here, measurements of doors, windows, rooms and any other items are approximate and no responsibility is taken for any error, omission, or mis-statement. This plan is for illustrative purposes only and should be used as such by any prospective purchaser. The services, systems and appliances shown have not been tested and no guarantee as to their operability or efficiency can be given
Made with Metropix ©2021

