



 **3**
Bedrooms

 **2**
Bathrooms



This extended three-bedroom family home is offered to the market with a large living area. To the ground floor you will find a large lounge and dining room that is currently a through lounge but has the benefit of French doors so easily sectioned off if you prefer separate seating areas, to the rear within the extension there is a large kitchen/breakfast room sweeping across the whole back of the property, there is also a guest's shower room located on the ground floor. To the first floor you will find all three bedrooms, the family bathroom and separate WC. Externally to the front there is off street parking with a side gate which takes you to the rear garden, in the rear garden you will find it is mainly hard standing with established flower beds, within the garden you will also find the properties garage which is accessed via a service road.

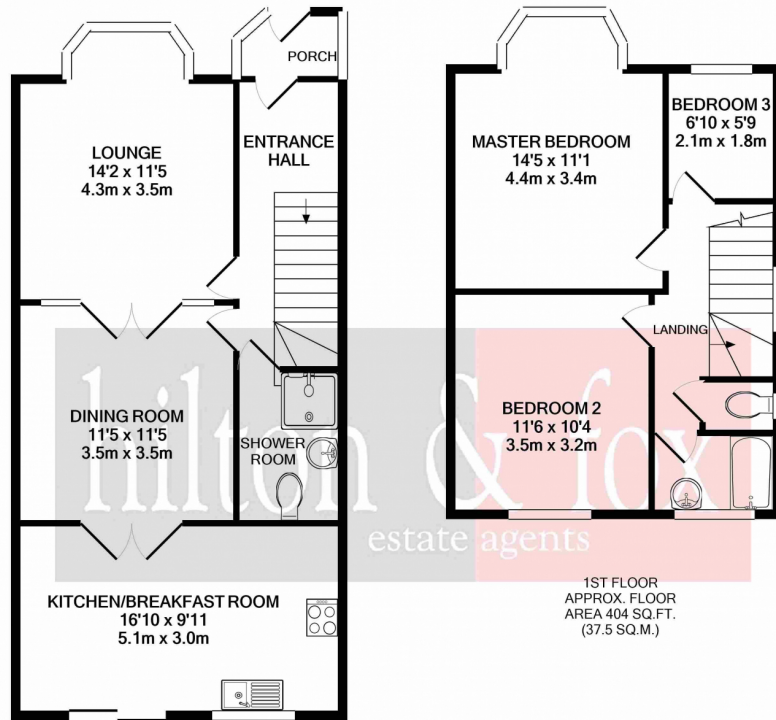

Whilst every attempt has been made to ensure the accuracy of the floor plan contained here, measurements of doors, windows, rooms and any other items are approximate and no responsibility is taken for any error, omission, or mis-statement. This plan is for illustrative purposes only and should be used as such by any prospective purchaser. The services, systems and appliances shown have not been tested and no guarantee as to their operability or efficiency can be given
Made with Metropix ©2021

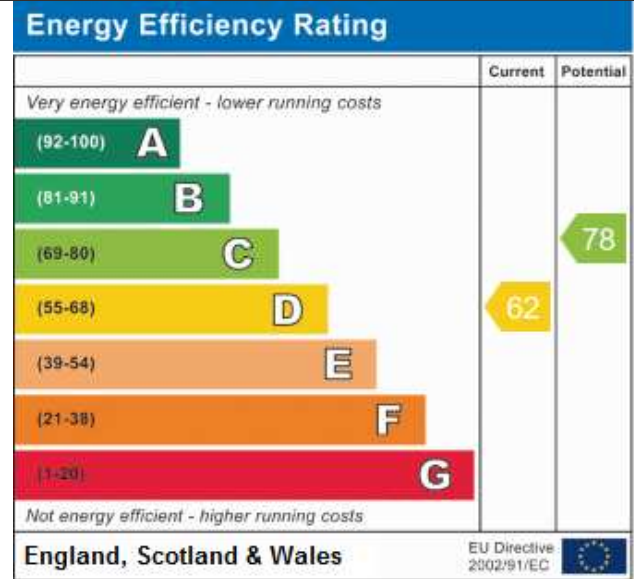



Technology College

East Lane Primary School

SIXT Car & Van Hire - London Wembley

North Wembley

Aroma Lounge

Wembley Primary School

King Edward VII Park

Barham Park

UNCLE Wembley

Primark

Ark Elvin Academy

Sudbury & Harrow Road

Wembley Central