



3

Bedrooms



1

Bathroom



Offered to the market with no further chain is this spacious Three-bedroom semi-detached family home. The property is located on this highly sought-after cul-de-sac in Perivale. Internally you will find that the property has to the ground floor a lounge, family kitchen which is open plan to the dining room (ideal for entertaining guests) and a sunroom. To the first floor you will find all three bedrooms, the family bathroom and separate WC. Externally to the front there is off street parking for a number of cars in addition to your garage which is accessed via a shared drive. To the rear there is a well-established and tendered private garden which backs directly onto the Grand Union Canal and thirteenth hole at Sudbury Golf Course. All in all, this is ready for a family to come into and add their own stamp to.

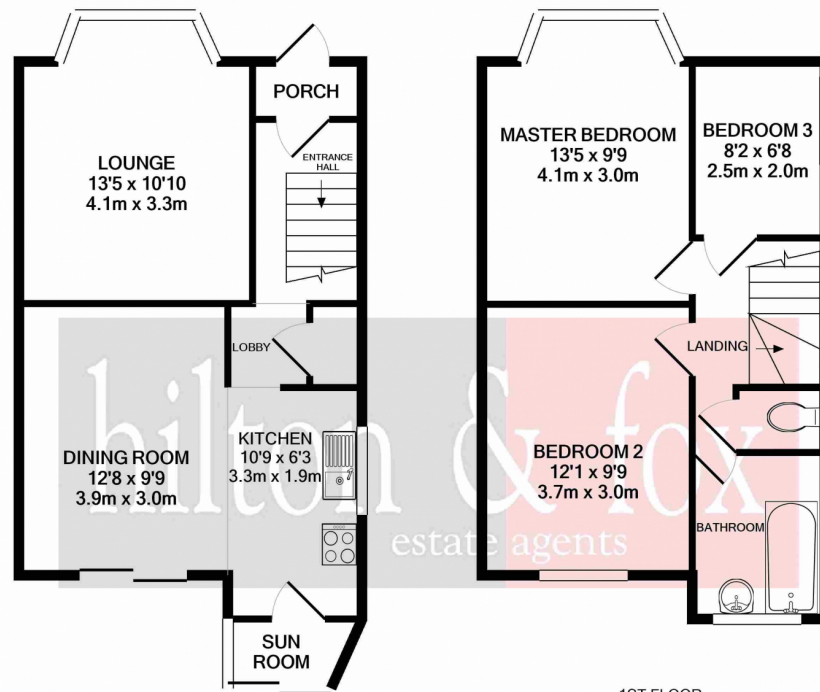

GROUND FLOOR
APPROX. FLOOR
AREA 425 SQ.FT.
(39.5 SQ.M.)

1ST FLOOR
APPROX. FLOOR
AREA 407 SQ.FT.
(37.8 SQ.M.)

TOTAL APPROX. FLOOR AREA 833 SQ.FT. (77.4 SQ.M.)

Whilst every attempt has been made to ensure the accuracy of the floor plan contained here, measurements of doors, windows, rooms and any other items are approximate and no responsibility is taken for any error, omission, or mis-statement. This plan is for illustrative purposes only and should be used as such by any prospective purchaser. The services, systems and appliances shown have not been tested and no guarantee as to their operability or efficiency can be given
Made with Metropix ©2021





Ballot Box

Horsenden Hill
Activity Centre - Disc...

Sudbury Golf Club

Horsenden Farm

Horsenden

Alperton Cemetery

Metropolitan Police
Perivale Car Pound

Hillview Surgery

Perivale Park
Industrial Estate

Elite Metalcraft

Kluseczka

Perivale Wood

Paddington
Branch