



 **6**  
Bedrooms

 **3**  
Bathrooms



Located just a stone's throw from the world-famous Wembley Stadium and having been looked after by the current vendors for many years is this Six-bedroom extended family home. Internally to the ground floor you will find a family lounge, bedroom, guests shower room and a spacious "Wren" fitted kitchen/diner. To the first floor you will find another three bedrooms and the family bathroom whilst to the top floor there is another two bedrooms and another shower room. Externally to the front there is off street parking for a number of cars whilst to the rear you will find a large north facing family garden with provides you fantastic views of Wembley Stadium. All in all, this is one not to be missed.

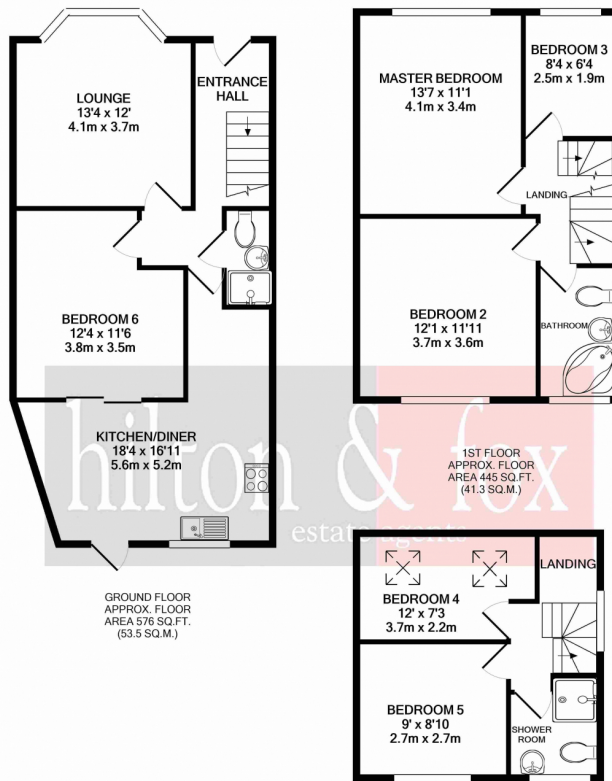

TOTAL APPROX. FLOOR AREA 1285 SQ.FT. (119.4 SQ.M.)  
 Whilst every attempt has been made to ensure the accuracy of the floor plan contained here, measurements of doors, windows, rooms and any other items are approximate and no responsibility is taken for any error, omission, or mis-statement. This plan is for illustrative purposes only and should be used as such by any prospective purchaser. The services, systems and appliances shown have not been tested and no guarantee as to their operability or efficiency can be given  
 Made with Metropix ©2021





# WEMBLEY PARK

The SSE Arena,  
Wembley

London Designer Outlet

ibis London Wembley

Wembley Stadium

Wembley Stadium

Costco Wholesale

Sherrans Farm  
Open Space

Oakington Manor  
Primary School

Monks Park