



4

Bedrooms



2

Bathrooms





Offered to the market with no further chain is this spacious Three/Four Bedroom Semi-detached Family Home. Internally to the ground floor you will see the property offers a spacious living area with a Reception Room/Forth Bedroom, two further lounges which combined are approx. 30ft in length, a dining room, family kitchen and shower room. To the first floor you will find three bedrooms, the family bathroom and separate WC. Externally to the front there is ample parking for a number of cars whilst to the rear a large family garden. All in all, this is one not to be missed.

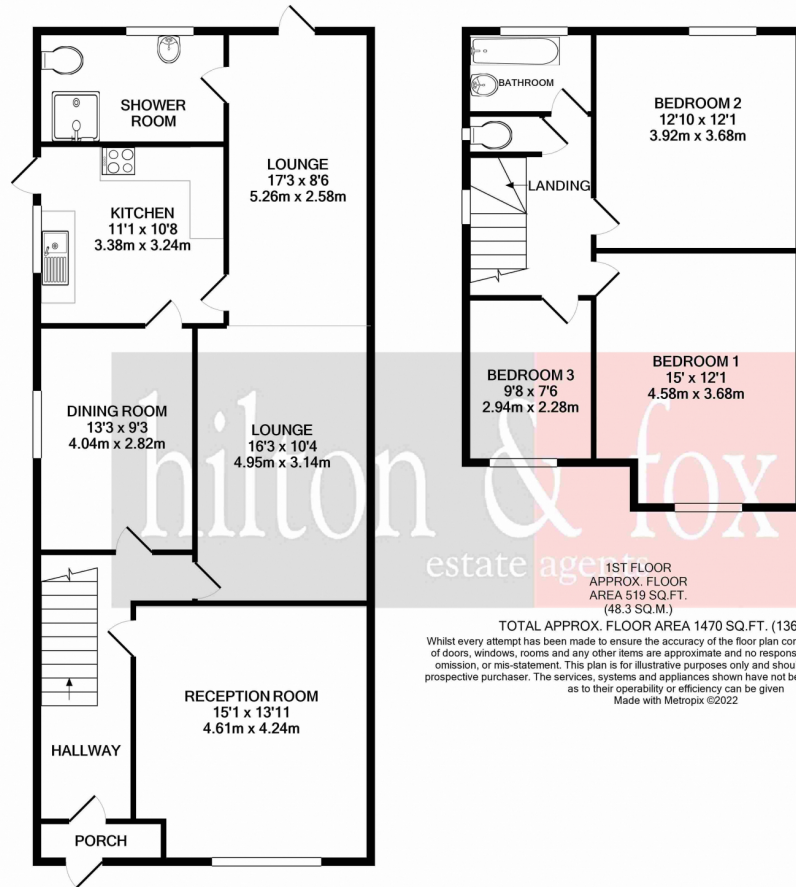

TOTAL APPROX. FLOOR AREA 1470 SQ.FT. (136.6 SQ.M.)

Whilst every attempt has been made to ensure the accuracy of the floor plan contained here, measurements of doors, windows, rooms and any other items are approximate and no responsibility is taken for any error, omission, or mis-statement. This plan is for illustrative purposes only and should be used as such by any prospective purchaser. The services, systems and appliances shown have not been tested and no guarantee as to their operability or efficiency can be given

Made with Metropix ©2022

**GROUND FLOOR**  
APPROX. FLOOR AREA 951 SQ.FT. (88.3 SQ.M.)

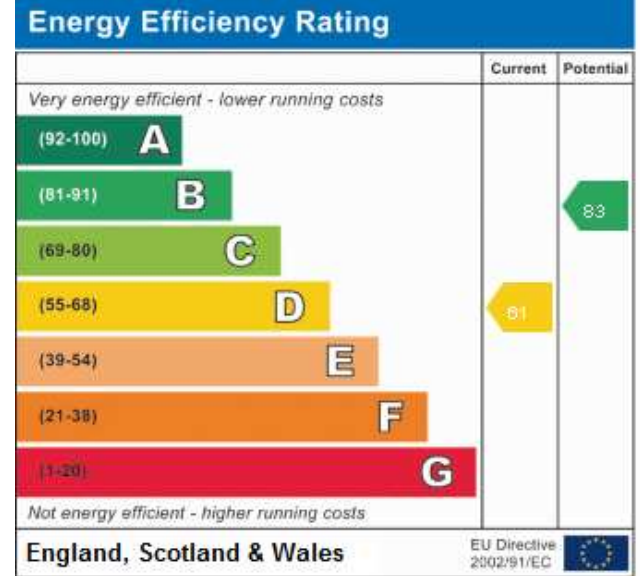





Wembley Police Station

Wembley Central

Sudbury Town

Wembley

Cha Sha Wembley

Sudbury Golf Club

A4005

Danethorpe Rd

Bassingthorpe Rd

Norton Rd

Thurby Rd

Popat Stores

Eagle Rd

VB & Sons Wembley

One Tree Hill  
Recreation  
Ground

Alpertons Cemetery

Alpertons  
Community School

Shri Vallabh Nidhi  
Mandir - Hindu...

Empire Rd

Jordan Rd

Alpertons Rd

Empire Rd

A4005

Mount Pleasant

London Shootfighters