



2 DOUBLE BEDROOMS

GROUND FLOOR

SPACIOUS

LONG LEASE

GOOD CONDITION

ALLOCATED PARKING

COMMUNAL GARDENS

SOUGHT AFTER LOCATION



Guide price £260,000

Guide price £260,000 to £280,000

Modern purpose built ground floor apartment situated in a sought after development in Chadwell Heath. The property is in good condition, offering 2 good size double bedrooms, modern fitted kitchen and bathroom, ample storage cupboards. Allocated parking space and well maintained green communal gardens.

Long lease of 132 years remaining.

Situated close to Chadwell Heath town centre and mainline train station providing easy access London Liverpool Street.

Main Entrance -

Communal entrance door with security door entry system leading to the apartment.

Entrance Hallway -

Entrance Hallway with tiled flooring and doors to rest of the accommodation.

Lounge area - 6.2m (20'0) x 5.2m (12'9)

Open plan large living room, access from hallway, radiator, laminate flooring, access to kitchen.

Kitchen - 2.9m (9'8) x 2.1m (6'10)

Modern fitted kitchen with a range of wall and base units. Stainless steel sink with mixer tap, integrated electric oven and 4 ring gas hob. Tiled floor and splashbacks, window to front.

Bedroom 1 - 4.0m (13'1) x 2.7m (8'11)

Large double bedroom, fitted wardrobe, double glazed window to rear, radiator, carpet laid.

Bedroom 2 - 4.4m (14'6) x 2.5m (8'2)

Double bedroom with double glazed window to rear, radiator, carpet laid, access from hallway.

Bathroom - 4.0m (9'8) x 3.1m (5'7)

Modern fitted 3 piece bathroom suite. Fully tiled walls and floor, window to front, fan and mirror cabinet.

Communal Gardens -

Well maintained residents communal gardens at rear.

Parking -

Allocated parking space for this apartment at front.

MONEY LAUNDERING REGULATIONS 2003 intending purchasers will be asked to produce identification and proof of financial status when an offer is received. We would ask for your co-operation in order that there will be no delay in agreeing the sale. THE PROPERTY MISDESCRIPTIONS ACT 1991 The Agent has not tested any apparatus, equipment, fixtures and fittings or services and so cannot verify that they are in working order or fit for the purpose. A Buyer is advised to obtain verification from their Solicitor or Surveyor. References to the Tenure of a Property are based on information supplied by the Seller. The Agent has not had sight of the title documents. A Buyer is advised to obtain verification from their Solicitor. You are advised to check the availability of this property before travelling any distance to view. We have taken every precaution to ensure that these details are accurate and not misleading. If there is any point which is of particular importance to you, please contact us and we will provide any information you require. This is advisable, particularly if you intend to travel some distance to view the property. The mention of any appliances and services within these details does not imply that they are in full and efficient working order. These particulars are in draft form awaiting Vendors confirmation of their accuracy. These details must therefore be taken as a guide only and approved details should be requested from the agents.

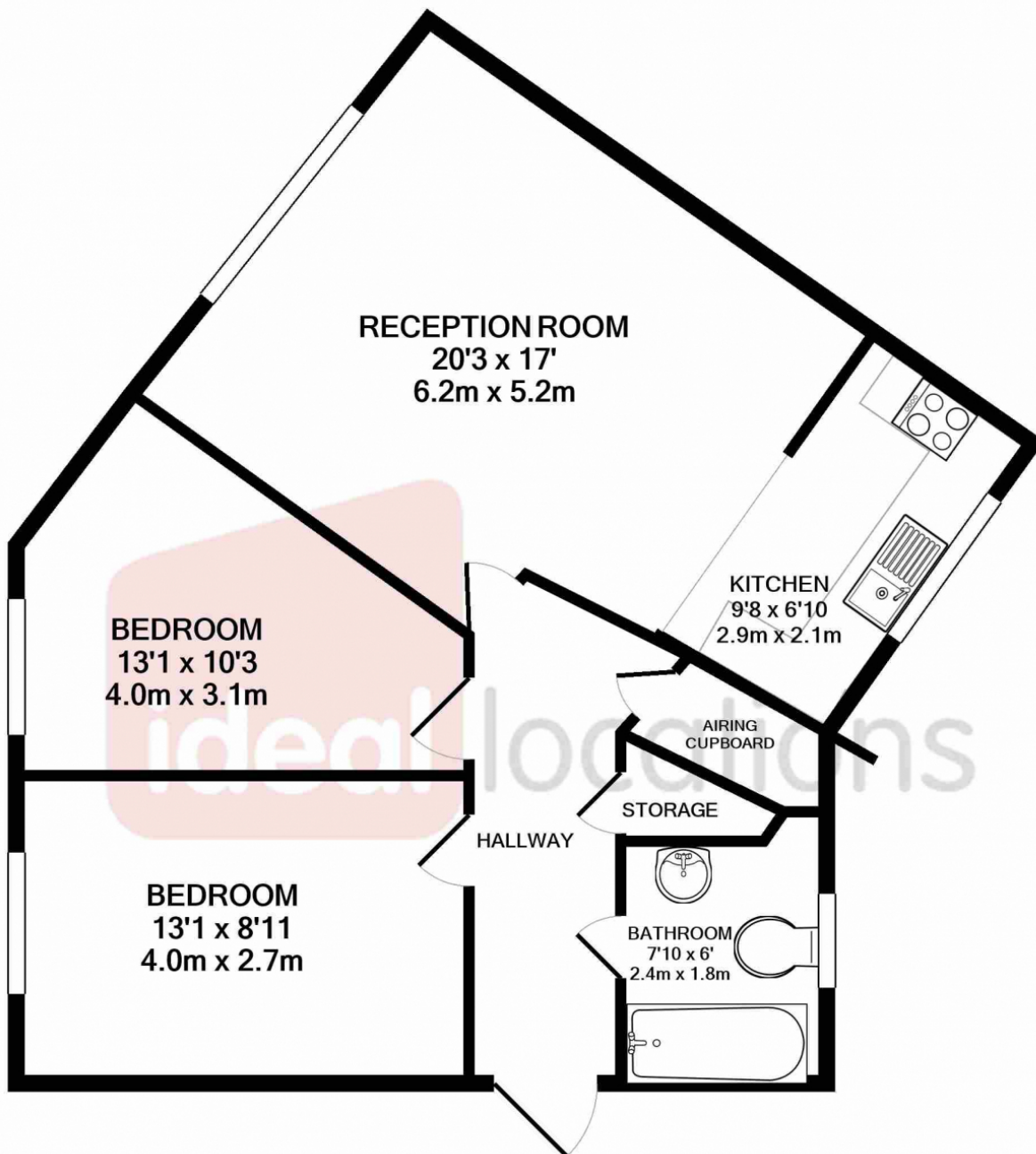

TOTAL APPROX. FLOOR AREA 625 SQ.FT. (58.1 SQ.M.)

Whilst every attempt has been made to ensure the accuracy of the floor plan contained here, measurements of doors, windows, rooms and any other items are approximate and no responsibility is taken for any error, omission, or mis-statement. This plan is for illustrative purposes only and should be used as such by any prospective purchaser. The services, systems and appliances shown have not been tested and no guarantee as to their operability or efficiency can be given

Made with Metropix ©2020



Coming soon