

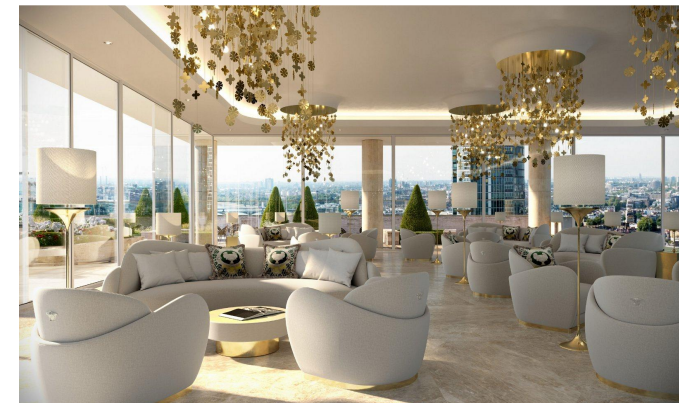

INTERLET

BONDWAY, NINE ELMS, LONDON, SW8  
FROM £6,500,000





A Versace inspired five double-bedroom penthouse apartment in this glamorous Tower development in Nine Elms, London SW8. Designed in an exclusive partnership with Versace, this development represents the height of modern luxury in Central London. Set on the 49th and 50th floors, the apartment offers spectacular views over the river and beyond, with famous landmarks such as the Houses of Parliament, Square Mile and The Shard. A luxury lifestyle development offering world-class amenities, including a gym and health & wellness centre set on the 23rd and 24th floors. Additionally, residents benefit from access to over 8,000sqft of gardens, children's play areas and parking facilities. Housekeeping is also available on request. The DAMAC Tower Nine Elms London is nestled between Vauxhall and Battersea, where a multi-billion pound investment is dramatically transforming the area into an ultra-modern residential and internationally significant business district, set to become a new centre for arts and culture in the capital. The area is close to the Vauxhall Cross rail and bus stations as well as the Underground. In addition, the new Northern Line extension and the Crossrail project are set to further increase transport links with the rest of London.[...]

[lettings@interlet.com](mailto:lettings@interlet.com)  
+44(0)20 7795 6525  
[www.interlet.com](http://www.interlet.com)



## Important Notice

Interlet and their clients give notice that: 1) They are not authorised to make or give any representations or warranties in relation to the property, either here or elsewhere. The particulars do not form part of any offer or contract and must not be relied upon as statements or representations of fact. 2) Any areas, measurements, and distances are approximate. The text, images, and plans are for guidance only and are not necessarily comprehensive. It should not be assumed that the property has all necessary planning, building regulation, or other contents. Interlet has not tested any services, equipment, or facilities. Prospective tenants must satisfy themselves by inspection or otherwise. Please note that the local area may be affected by aircraft noise, you should make your own inquiries regarding any noise in the area before you make an offer.





# interlet

SALES & LETTINGS

Welcome home.