



3

Bedrooms



1

Bathroom



Three bedrooms, a first floor bathroom., additional ground floor WC with a modern feel throughout are all on offer with this end terrace family available with immediate effect. We are the Sole agents so call our Dagenham office without delay to avoid missing out

Three bedrooms, a first floor bathroom., additional ground floor WC with a modern feel throughout are all on offer with this end terrace family available with immediate effect. We are the Sole agents so call our Dagenham office without delay to avoid missing out

Lounge/Diner 14' 11" x 14' 8" Max(4.5m x 4.5m)

Kitchen 9' 4" x 8' 10" (2.8m x 2.7m)

Ground floor cloakroom 4' 10" x 2' 9" (1.5m x 0.8m)

Landing
Doors to

Bedroom One 12' 10" x 8' 8" (3.9m x 2.7m)

Bedroom Two 11' 4" x 7' 8" (3.5m x 2.3m)

Bedroom Three 7' 9" x 7' 0" (2.4m x 2.1m)

Bathroom 8' 9" x 5' 12" (2.7m x 1.8m)

Rear garden approx. 19' 12" (6.1m)

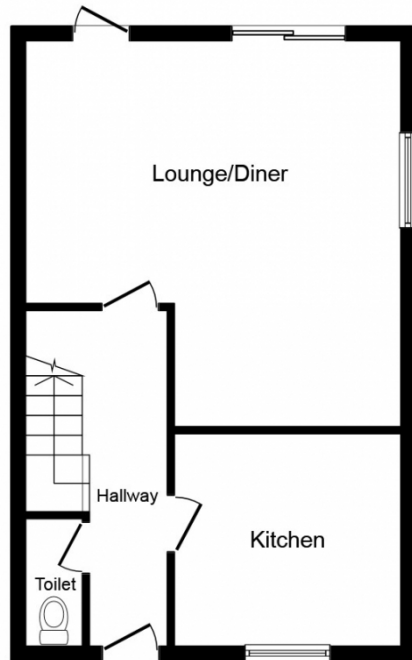

Ground Floor

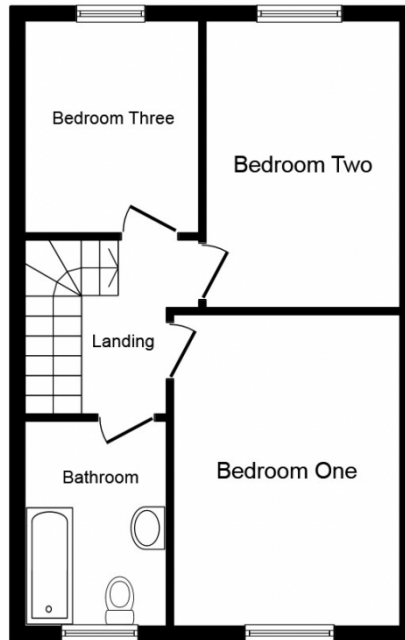

First Floor

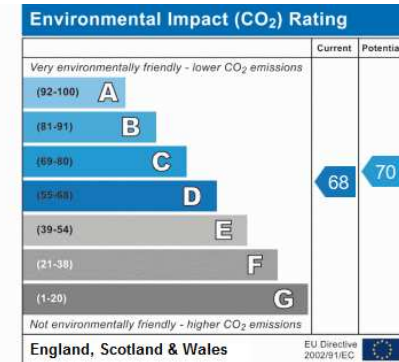
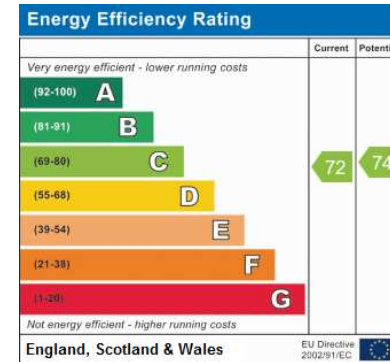

This plan is for illustration purposes only and may not be representative of the property. Plan not to scale.