



Guide price £400,000
Oglethorpe Road, Dagenham, RM10



 3
Bedrooms

 1
Bathroom

294 Heathway, Dagenham, Essex, RM10 8LU |
dagenham@ramseymoore.co.uk

02085366600



Guide price £400,000
Oglethorpe Road, Dagenham, RM10



Guide Price - £400,000 - £425,000.

Ramsey Moore are delighted to be able to offer for sale this double fronted three bedroom family home, located in this popular turning just off the Heathway, and therefore within easy access of local shopping and transport facilities. The property consists of: Through lounge, Open plan kitchen/diner and first floor shower room. With further benefits to include: Gas central heating, double glazing and rear garden. An early viewing is highly advised to fully appreciate all that is on offer.

Guide Price - £400,000 - £425,000.

Ramsey Moore are delighted to be able to offer for sale this double fronted three bedroom family home, located in this popular turning just off the Heathway, and therefore within easy access of local shopping and transport facilities. The property consists of: Through lounge, Open plan kitchen/diner and first floor shower room. With further benefits to include: Gas central heating, double glazing and rear garden. An early viewing is highly advised to fully appreciate all that is on offer.

Entrance

Via door to porch with further door to hallway

Hallway

Laminate wood flooring, staircase to first floor, doors to

Through Lounge *6.23m x 3.19m (20.44ft x 10.47ft) Max*

Laminate wood flooring, 2 radiators, Upvc window to front, Upvc French doors to garden

Dining Area *4.28m x 3.72m (14.04ft x 12.20ft)*

Laminate wood flooring, radiator, Upvc window to front

Kitchen *2.90m x 2.19m (9.51ft x 7.18ft)*

Range of fitted wall and base units with roll top work surfaces. One and a half bowl stainless steel single drainer sink unit with mixer taps. Tiled splash backs. Stainless steel extractor hood. Spaces for washing machine, fridge freezer and cooker. Built in cupboard. Upvc window to rear. Upvc door to garden.

Landing

Built in cupboard housing boiler, access to loft, doors to

Bedroom One *4.81m x 2.73m (15.78ft x 8.96ft)*

Two Upvc windows to front, radiator.

Bedroom Two *3.32m x 2.54m (10.89ft x 8.33ft)*

Upvc window to front, radiator

Bedroom Three *2.36m x 1.98m (7.74ft x 6.50ft)*

Upvc window to rear, radiator, built in cupboard

Shower Room *1.75m x 1.28m (5.74ft x 4.20ft)*

Corner shower cubical, pedestal wash hand basin, low level wc, tiled splash backs, chrome effect heated towel rail, Obscure glazed Upvc window to rear.

Rear Garden

Approx 35ft, crazy paved patio area leading to lawn. Outside light and water tap.



Guide price £400,000
Oglethorpe Road, Dagenham, RM10

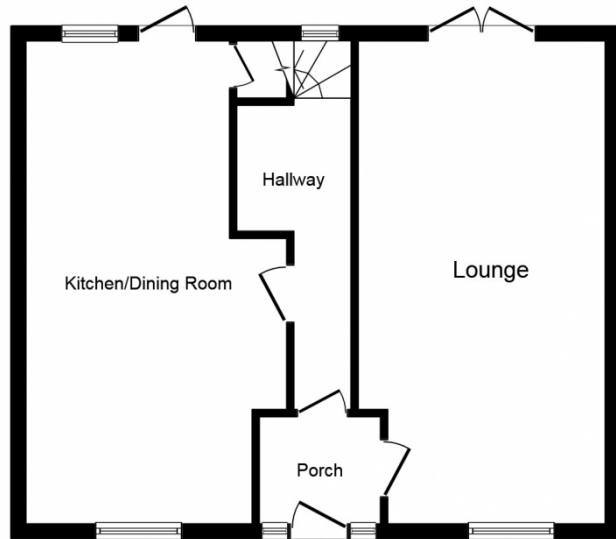

Ground Floor

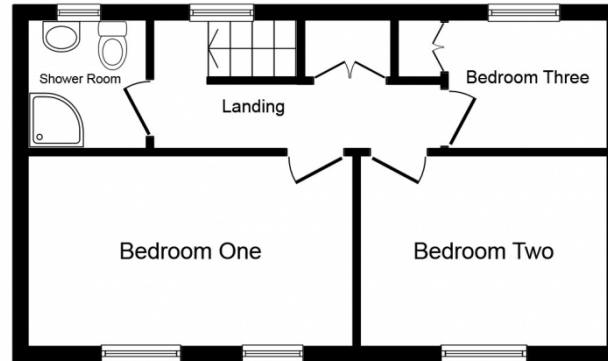

First Floor

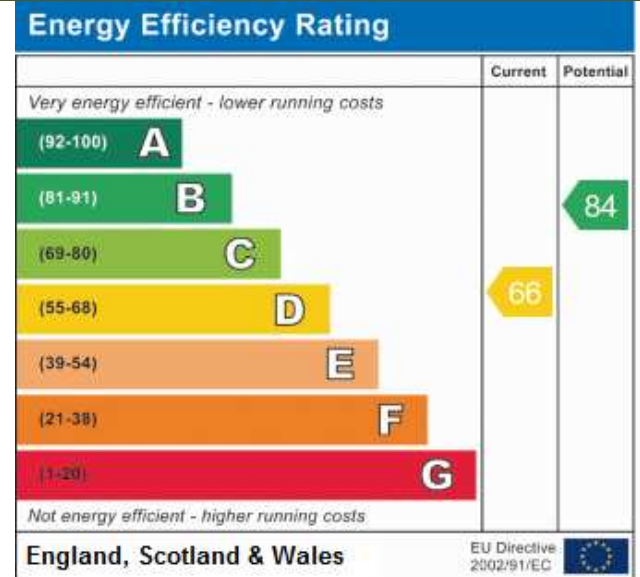

This plan is for illustration purposes only and may not be representative of the property. Plan not to scale.

