

 **1**
Bedroom

 **1**
Bathroom



A very well presented one bedroom first floor flat in an ultra-convenient location tucked away on a quiet cobbled mews in prime central Wimbledon. Benefits include an open-plan kitchen living area, tiled bathroom and bright double bedroom with a large velux window. Contemporary finish throughout. Moments from Wimbledon high street, station and the many local shops and amenities.

A very well presented one bedroom first floor flat in an ultra-convenient location tucked away on a quiet cobbled mews in prime central Wimbledon. Benefits include an open-plan kitchen living area, tiled bathroom and bright double bedroom with a large velux window. Contemporary finish throughout. Moments from Wimbledon high street, station and the many local shops and amenities.

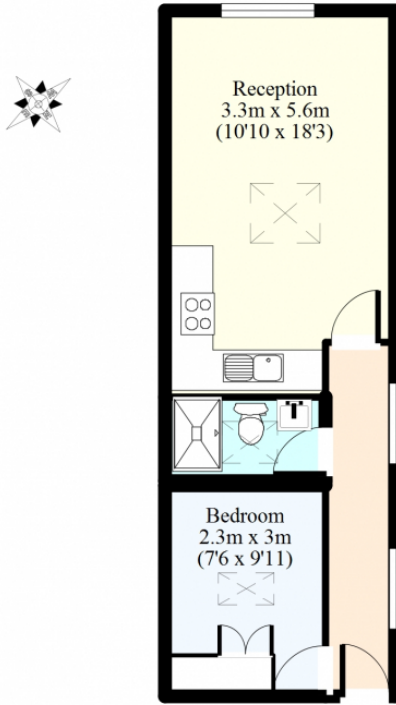

33 sq. m / 350 sq. ft

Worple Road Mews SW19 4DB

Whilst every attempt has been made to ensure the accuracy of the floor plan contained here, measurements of doors, windows, rooms and any other items are approximate and no responsibility is taken to any error, omission, or mis-statement. This plan is for illustrative purpose only and should not be tested and no guarantee prospective purchaser. The service, system and appliances shown have not been tested and no guarantee as to their operability or efficiency can be given
(c) PRESTVILLE LTD WWW.HOMESURVEY4U

