

Offers over £198,000
Henley Road, Walsgrave, Coventry, CV2 2FY



**VIEW 360°
VIRTUAL TOUR**



 **3**
Bedrooms

 **2**
Bathrooms



****CLOSE TO HOSPITAL, M6 AND SHOPS**** A well-presented three-bedroom mid terraced family home located in a popular residential area of Coventry. Briefly comprising of entrance hallway, lounge, kitchen/diner with oven, gas hob, space for appliances, storage cupboard, conservatory. To the first floor are three well-proportioned bedrooms with two of the rooms benefitting from built-in storage cupboards, part tiled white suite family bathroom with an electric shower over the bath. Outside to the front is a lawned garden with the possibility of a driveway (subject to planning) and to the rear is a patio area, lawned garden and a summer house with an electricity supply. Other features included an outside toilet, double glazing, gas central heating (combi boiler approx. 7yrs old), alarm system, CCTV. ENERGY RATING C.

Notes: Please view are virtual 360 viewing before booking a physical viewing.

Combi Worcester boiler approx. 7 yrs old. Last serviced 2020. Loft not boarded.

Reason for the move – Downsizing.

Measurements in feet.

Hallway – Consumer unit and electric meter location.

Kitchen/Diner – 17.93 ft X 9.47ft – Storage cupboard with gas meter.

Conservatory – 7.95ft X 15.87ft

Bathroom – 9.76ft X 7.88 ft

Bedroom 3 - (front single) – with a storage cupboard -10.74ft X 5.16ft

Bedroom 1 - (front master) – with built-in wardrobes – 10.29ft X 11.98ft

Bedroom 2 - (rear double) – 9.89ft X 9.55ft

Landing – Loft hatch access.

528 Henley Road, Coventry, CV2 2FY

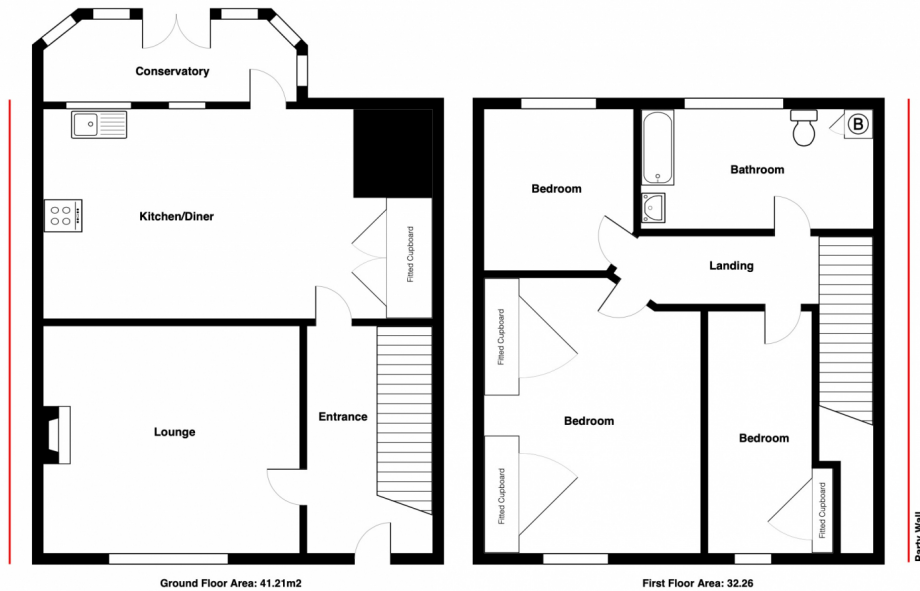

All measurements are approximate and for display purposes only
Total Area: 73.47 sq m²

