

Figured Dimensions Only To Be Taken From This Drawing  
Do Not Scale.

DESIGNERS RISK ASSESSMENT

At all times the Contractor shall strictly observe the requirements of the Health & Safety at Work, etc. Act 1974 and all relevant health & safety regulations relating thereto, including where applicable the Construction (Design and Management) Regulations, 2015. Without prejudice to the generality of the foregoing, the attention of the Contractor is specifically drawn to any principal residual hazards where noted in this or any accompanying documents. The risks are associated therewith must be adequately and effectively managed, using all suitable and appropriate measures to safeguard all work persons, building occupants, visitors, adjoining occupants and members of the public from harm or injury.

The Contractor must comply fully with the Construction (Health, Safety and Welfare) Regulations 1996 and provide any necessary equipment, offices, welfare facilities and the like to ensure a safe place of work.

Allow all costs in complying with the relevant Codes, Regulations, Agreements and Statutes governing welfare facilities relating to the Building Industry and provide attendance and maintain all amenities throughout the duration of the contract to a suitable standard.

The Contractor shall indemnify the Employer against any liability for claim, or in legal proceedings, resulting from any breach of the relevant legislation.

The Contractor shall have regard particularly to the following health and safety matters in that:-

- He has a clearly defined safety policy and that all site operatives (including sub-contractors are aware of it.
- He has established satisfactory and safe systems of working and storage (including chemical and flammable liquid storage).
- He provides all sanitary, welfare, canteen and first aid facilities.
- Safe passage is maintained by the Contractor for pedestrians near the Works.
- Have pre-determined emergency procedures including those for fire prevention and escape.
- Monitoring procedures to ensure compliance with site safety rules, selection and management procedures, health and safety standards and statutory requirements.

For the purpose of this project the General Contractor will assume the responsibilities of the Principal Designer.

The property owner is to ensure all mandatory consents (where applicable) are in place prior to commencement - planning consent, building regulation approval, 1996 party wall act, water authority building over agreement etc.

Before any demolition of structural elements of the existing structure an assessment is to be made to ensure the extent of the load-bearing element is to be made - ie check loadings before demolishing walls.

Preliminary  
FLOOR PLANS

A	1.7.19	BED 2 DOOR REPOSITIONED
A	20.6.19	CLIENT AMENDMENTS

Proposed:  
House of Multiple Occupation,  
Flat 1 - 45 Church Street,  
Tamworth.  
B79 7DE

Scale:	Job No.	Dwg No.	Rev.
1:50 @ A1	1343 - 40		B
AF	Dwn.		Date, Mar. 2019

HALAS

P B C

173 Lower High Street,  
Stourbridge,  
West Midlands,  
DY8 1TG

ARCHITECTURAL/BUILDING  
DESIGN CONSULTANTS  
Office: 01384 444472 (Mob: 07980 145997)  
E-mail: enquiries@halasbpc.co.uk www.halasbpc.co.uk

Flat 1- 45 Church Street, Tamworth.

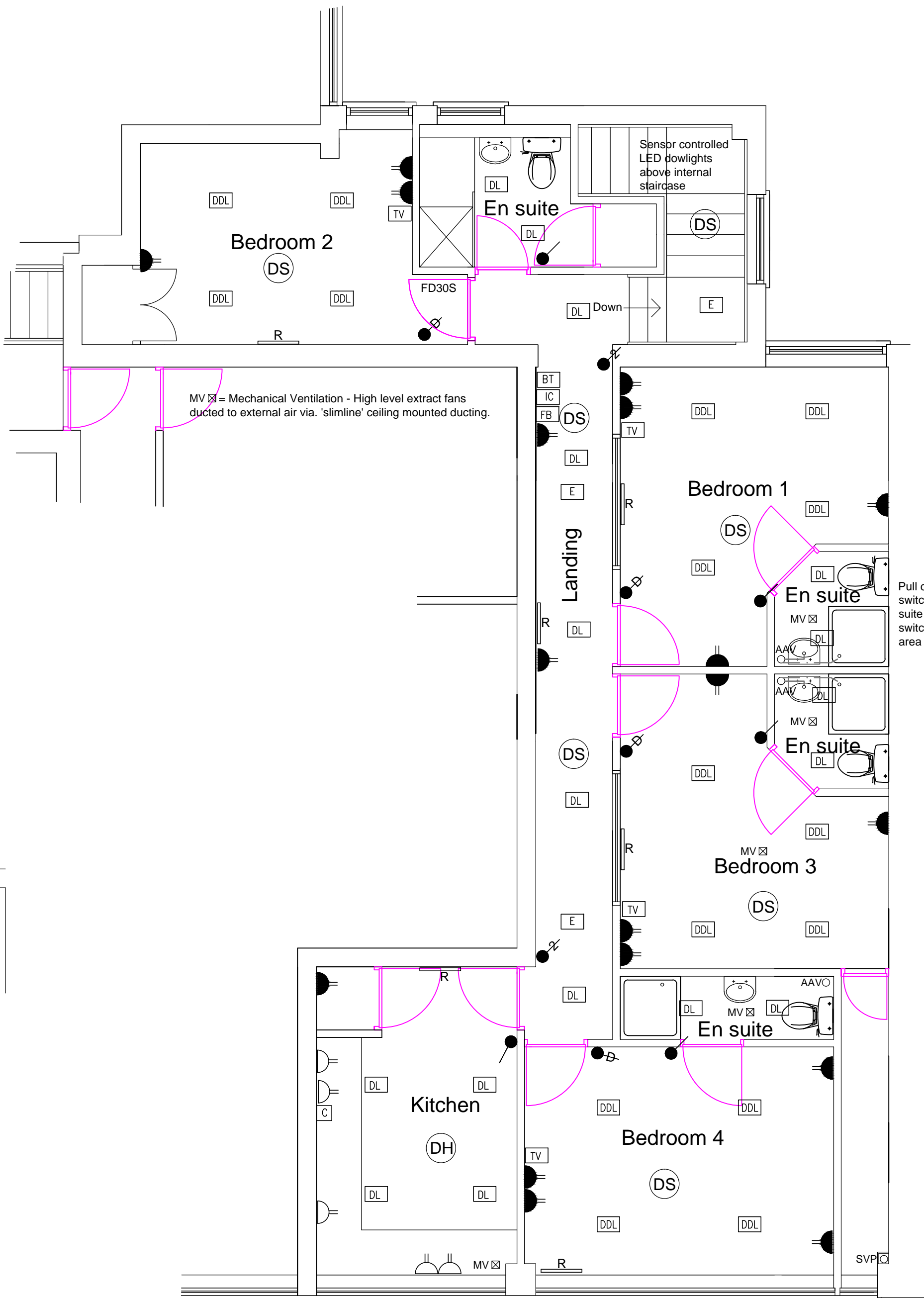

Electrical legend:

- 13A twin switched socket low level.
- switched spur low level.
- 13A twin switched socket high level with integrated USB port
- Dimmable wall mounted light switch.
- Wall mounted light switch.
- 2 way mounted light switch.
- ceiling mounted pendant light.
- Downlighters
- Dimmable Downlighters
- television aerial socket.
- cooker point
- gas point
- extract fan.
- telephone socket
- Radiator
- New fuse box
- Emergency Light
- Intercom

ceiling mounted light fitting which will only accept lamps with a luminous efficacy of greater than 40 lumens per circuit watt ( ie compact fluorescent lamps )  
House with 10-12 rooms must have minimum 4 located in most used rooms

External light fittings should only accept lamps with a luminous efficacy of greater than 40 lumens per circuit watt ( ie compact fluorescent lamps )  
alternative to above is to have all external lights connected to light sensitive switch which will switch lights off during daylight hours

Smoke and heat detectors should be mains-operated and conform to BS EN14604:2005, Smoke Alarm devices or BS5446-2:2003. Fire detection and fire alarm devices for dwelling houses, Part 2 specification for heat alarms respectively. (With battery backup)

GROUND FLOOR -  
ELECTRIC PLAN

FIRST FLOOR - ELECTRIC PLAN

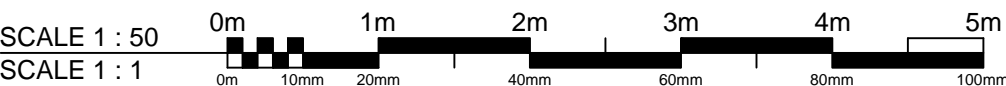

SERVICE LAYOUTS