



 2
Bedrooms

 1
Bathroom





TRADING PLACES ESTATE AGENTS are delighted to offer for sale this superbly presented two bedroom COTTAGE WITH A LARGE GARDEN, DRIVEWAY AND GARAGE which really must be viewed to be fully appreciated. If you are looking for a property with charm, character & finished to a high standard be sure to take a look. In brief the accommodation comprises modern fitted kitchen, dining room, lounge, shaped landing, the two well proportioned bedrooms & a four piece bathroom suite, The property is warmed by gas central heating & is fully uPVC double glazed. Externally to the rear there is a large garden. and to the front a driveway leading to a single garage. This particular plot is off a good size with the potential of building a separate dwelling (Subject to planning permission) A short walk from the amenities of the area.

GROUND FLOOR
380 sq.ft. (35.3 sq.m.) approx.

1ST FLOOR
383 sq.ft. (35.5 sq.m.) approx.

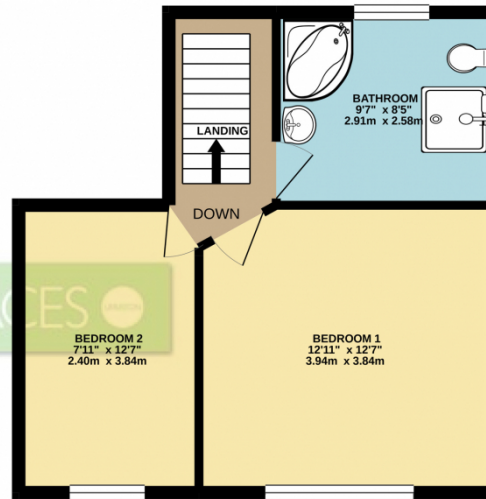

TOTAL FLOOR AREA : 763 sq.ft. (70.9 sq.m.) approx.

Whilst every attempt has been made to ensure the accuracy of the floorplan contained here, measurements of doors, windows, rooms and any other items are approximate and no responsibility is taken for any error, omission or mis-statement. This plan is for illustrative purposes only and should be used as such by any prospective purchaser. The services, systems and appliances shown have not been tested and no guarantee as to their operability or efficiency can be given.
Made with Metropix ©2020

