



1

Bedroom



1

Bathroom





TRADING PLACES are pleased to have available this first floor one bedroom retirement apartment situated in the ever popular 'Braeside' on Urmston Lane. Good local public transport to Urmston or Stretford, short walk to Stretford Metrolink or Stretford Mall. Briefly the accommodation comprises of entrance hall, lounge, fitted kitchen, bedroom and bathroom. There is a communal lounge area and laundrette and stairwell and lift to all floors. A guest room is available to book via appointment and there is a House Manager available on site. Outside: Communal gardens and residential parking available.

Communal entrance door

Access to communal lounge, laundrette, stairwell and lift to all floors.

Entrance door into hall

Mirrored sliding door storage.

Lounge *3.79m x 4.15m*

UPVC double glazed window. Fireplace with electric insert. Storage heater. TV point.

Kitchen *2.09m x 2.09m*

UPVC double glazed window. Fitted with a range of wall and base units incorporating a stainless steel sink unit with hot and cold taps. Free standing electric cooker with cooker hood over. Space for fridge/freezer. Tiled to compliment.

Bedroom *2.50m x 3.27m*

UPVC double glazed window. Storage heater. Fitted mirrored sliding door wardrobe.

Bathroom *1.84m x 2.02m*

Fitted suite comprising of walk-in bath, with shower over, pedestal wash hand basin and a low level WC Tiled to compliment.

GROUND FLOOR
411 sq.ft. (38.2 sq.m.) approx.

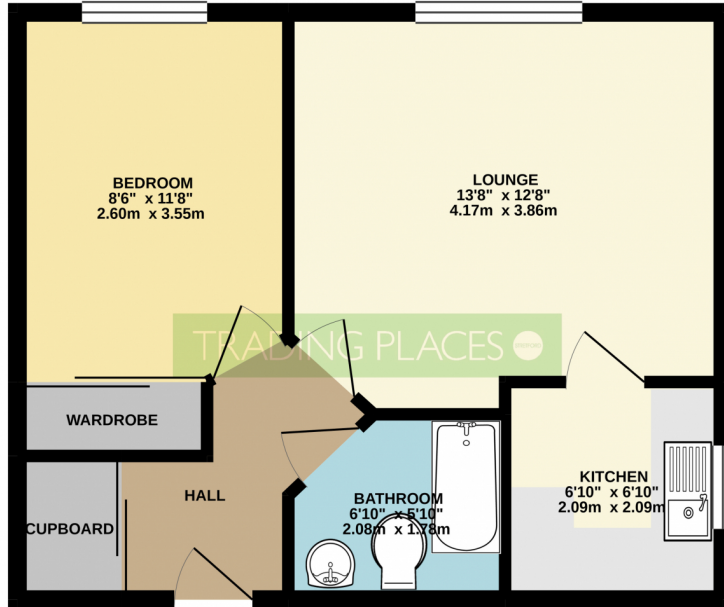

TOTAL FLOOR AREA - 411 sq.ft. (38.2 sq.m.) approx.
Whilst every attempt has been made to ensure the accuracy of the floorplan contained here, measurements of doors, windows, rooms and any other items are approximate and no responsibility is taken for any error, omission or mis-statement. This plan is for illustrative purposes only and should be used as such by any prospective purchaser. The services, systems and appliances shown have not been tested and no guarantee as to their operability or efficiency can be given.
Made with Metropix ©2020

