



 2
Bedrooms

 1
Bathroom





An immaculately presented & spacious, TWO BEDROOMED, occupying the first floor within this purpose built-development for the over 60's. Situated in this highly popular development with open views into Longford Park opposite here in Stretford. Located between either the centre of Chorlton and Stretford with all its local amenities, good bus routes and the Stretford Metrolink station on Edge Lane. This well-planned apartment comprises; communal entrance hallway, communal lounge/dining room with a kitchen area, private entrance hallway, a lift and stairs to all floors, private entrance hallway, two bedrooms, a three-piece white shower room, a spacious lounge/dining room with views and a separate fitted kitchen. The apartment benefits from double glazing throughout, warmed by electric heating, 24-hour emergency care line response system, an on-site house manager, communal mature lawned gardens to the front, side and rear aspect and off-road parking to the rear aspect for both residents and visitors. **VENDOR WOULD CONSIDER OFFERING WITH NO CHAIN.** Internal inspection is highly recommended.

Entrance Hallway - 16'6" x 14' 5" (5.03m x 4.27m 0.13m) - Secure telephone entry system. Entrance hall with sliding door mirror cloak cupboard.

Lounge - 17'4" x 10'4" (5.28m x 3.15m) - Spacious and light lounge with two UPVC double glazed windows to side and rear elevation. TV Point. Coving to the ceiling. Electric fire with feature wood fire surround. Night storage heater.

Kitchen - 6'10" x 6'8" (2.08m x 2.03m) - UPVC double glazed window to side elevation. Fitted with a range of wall and base units with roll edge work surfaces incorporating a stainless steel single drainer sink unit. Space for free standing cooker and fridge freezer.

Bedroom One - 13'11" x 8'11" (4.24m x 2.72m) - Double glazed window to rear elevation. Fitted wardrobes with over bed storage. Night storage heater.

Bedroom Two - 13.3" x 6'5" (0.33m x 1.96m) - Double glazed window to side elevation. Night storage heater. Built in wardrobes.

Bathroom - 6'8" x 6'5" (2.03m x 1.96m) - Fitted bathroom suite comprising:- Walk in power shower, pedestal wash hand basin and low level WC. Tiled to compliment.

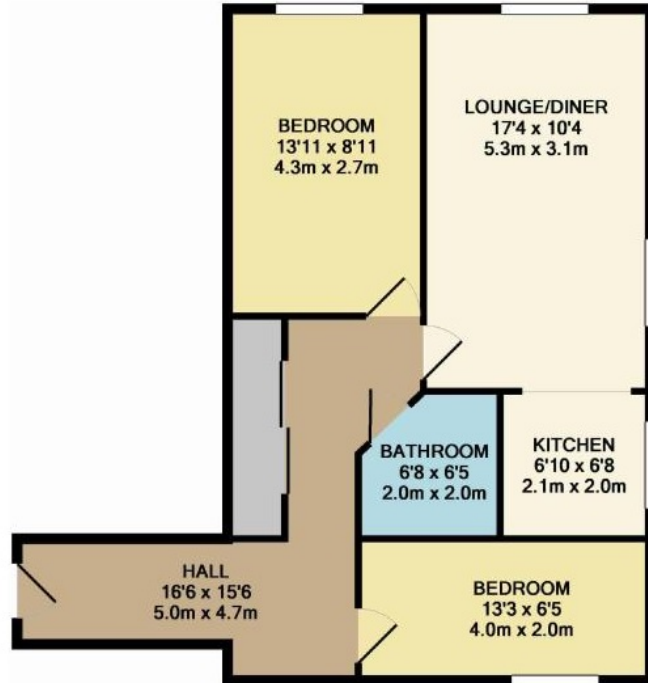

TOTAL APPROX. FLOOR AREA 631 SQ.FT. (58.6 SQ.M.)
Made with Metropix ©2015

