

TRADING PLACES ●

Offers over £160,000
Cross Lane East, Partington, M31



 **3**
Bedrooms

 **1**
Bathroom

42 Flixton Road , Urmston, Manchester, M41 5AB |
lee@tradingplacesurmston.co.uk

01617470022





****NO ONWARD CHAIN** - **SUPERB OPEN VIEWS TO THE FRONT** - TRADING PLACES ESTATE AGENTS** are pleased to offer for sale this well presented **THREE BEDROOM** semi detached property benefiting from open aspect views to the front of the property overlook a communal park. This property is uPVC double glazed and solar panels and in brief, the attractive accommodation comprises; entrance hallway, living room, a fitted kitchen/diner. To the first floor there are well proportioned bedrooms and a family bathroom with a separate WC. Externally there is gardens to both the front and rear of the property.

GROUND FLOOR
415 sq.ft. (38.5 sq.m.) approx.

1ST FLOOR
421 sq.ft. (39.1 sq.m.) approx.

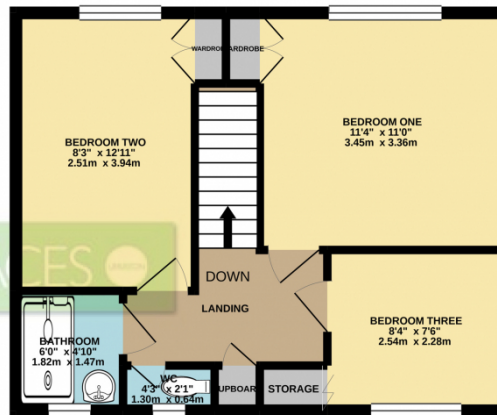

TOTAL FLOOR AREA : 836 sq.ft. (77.6 sq.m.) approx.

Whilst every attempt has been made to ensure the accuracy of the floorplan contained here, measurements of doors, windows, rooms and any other items are approximate and no responsibility is taken for any error, omission or mis-statement. This plan is for illustrative purposes only and should be used as such by any prospective purchaser. The services, systems and appliances shown have not been tested and no guarantee as to their operability or efficiency can be given.
Made with Metropix ©2021

