

TRADING PLACES ●

Offers over £210,000
Mitford Street Stretford M32



 2
Bedrooms

 1
Bathroom

133, Barton Road, Stretford, Manchester, M32 8DN |
admin@tradingplaces.co.uk

01618659220





TRADING PLACES are pleased to have available this street fronted two bedroom middle terrace property which benefits from double glazing and gas central heating. Briefly the accommodation comprises of entrance hall, lounge and an open plan dining room/kitchen, whilst to the first floor there are two bedrooms and a bathroom. Outside: Street fronted. Gated courtyard to rear.

The property is situated in a much sought after location of Stretford, walking distance to the Mall and the Metro-link. Great catchment area for the local schools, lovely Victoria Park just around the corner and walking distance to Longford Park. Good local public transport to the surrounding areas such as The Trafford Centre and Manchester City Centre.

Entrance hall *2.01m x 3.93m*

Entrance door. Wood floor. Staircase to first floor. Radiator. Dado rail.

Lounge *3.10m x 3.30m*

Double glazed window to front elevation. Wood floor.

Kitchen/dining room *4.70m x 5.30m*

Double glazed window to rear. Wood floor to the dining area. Vertical radiator. Fitted with a range of wall and base units incorporating a ceramic sink unit with mixer tap. Tiled splash back. Integrated oven and a four ring gas hob over and a stainless steel chimney style extractor over. Plumbed for automatic washing machine. Space for fridge/freezer. Breakfast bar. Tiled kitchen floor area. Double glazed door to the courtyard.

Landing

Bedroom one *3.50m x 4.70m*

Two double glazed windows to front elevation. Wood floor. Radiator. Coving to ceiling. Picture rail.

Bedroom two *2.80m x 4.00m*

Double glazed window to rear elevation. Coving to ceiling. Picture rail. Carpet.

Bathroom *2.00m x 3.10m*

Fitted suite comprising of P shaped bath with shower and shower screen, pedestal wash hand basin and a low level WC. Wood floor. Tiled splash backs. Ladder style heated radiator. Double glazed window.

Outside

Street fronted. Gated courtyard to the rear.

GROUND FLOOR
510 sq.ft. (47.3 sq.m.) approx.

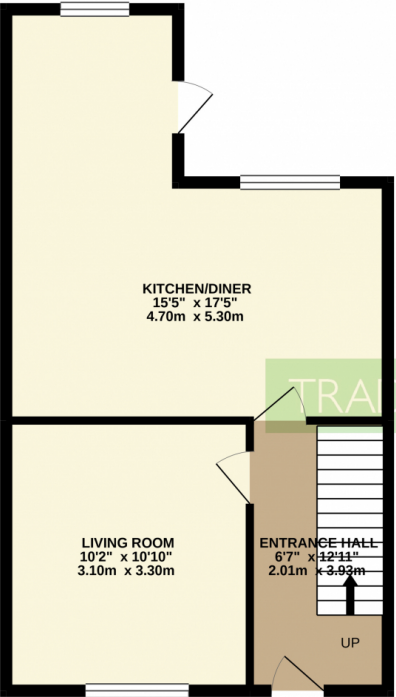

1ST FLOOR
442 sq.ft. (41.0 sq.m.) approx.

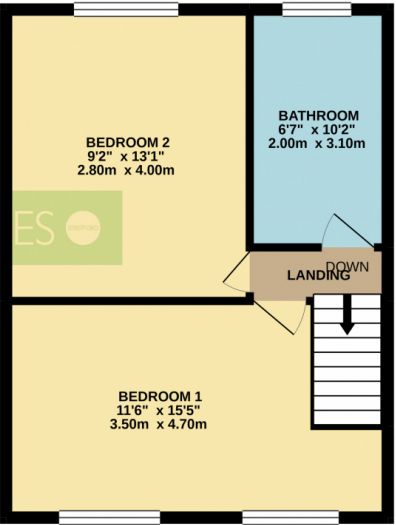

TOTAL FLOOR AREA : 951 sq.ft. (88.4 sq.m.) approx.

Whilst every attempt has been made to ensure the accuracy of the floorplan contained here, measurements of doors, windows, rooms and any other items are approximate and no responsibility is taken for any error, omission or mis-statement. This plan is for illustrative purposes only and should be used as such by any prospective purchaser. The services, systems and appliances shown have not been tested and no guarantee as to their operability or efficiency can be given.
Made with Metropix ©2021

