



Bedroom



Bathroom





ONE BEDROOM RETIREMENT FLAT ON THE POPULAR BRAESIDE DEVELOPMENT ON URMSTON LANE

SOLD WITH NO CHAIN!!

TRADING PLACES are pleased to have available this second floor one bedroom retirement apartment situated in the ever popular 'Braeside' on Urmston Lane. Good local public transport offering easy access in Urmston Town Centre or Stretford, Mall with the new food market. It is a short walk to Stretford Metrolink offering quick access into The City Centre, Media City and the Trafford Centre. Briefly the accommodation comprises of entrance hall, lounge, fitted kitchen, bedroom and bathroom. There is a communal lounge area and laundrette and stairwell and lift to all floors. A guest room is available to book via appointment and there is a House Manager available on site.

Outside: Communal gardens and residential parking available.

Communal Entrance

Access to communal lounge, laundrette, stairwell and lift to all floors.

Hall

Front door opening to entrance hall with mirrored cloakroom storage cupboards.

Lounge *3.74m x 4.07m*

Double glazed window to side elevation. Wall mounted electric fire. Electric storage heater.

Kitchen *2.11m x 2.02m*

Fitted with a range of modern white wall and base units with contrasting work tops. Integrated electric hob with oven below and chimney style extractor above. Stainless steel sink unit with mixer tap. Laminate floor. Double glazed bay window to side elevation.

Bedroom One *3.74m x 2.52m*

Double glazed window to side elevation. Fitted mirrored wardrobe. Storage heater.

Bathroom *1.84m x 1.91m*

White bathroom suite fitted with a walk in shower with sliding doors, pedestal wash hand basin and WC. Tiled walls to compliment. Laminate flooring.

Communal Lounge

Communal lounge for residents and visitors.

GROUND FLOOR
395 sq.ft. (36.7 sq.m.) approx.

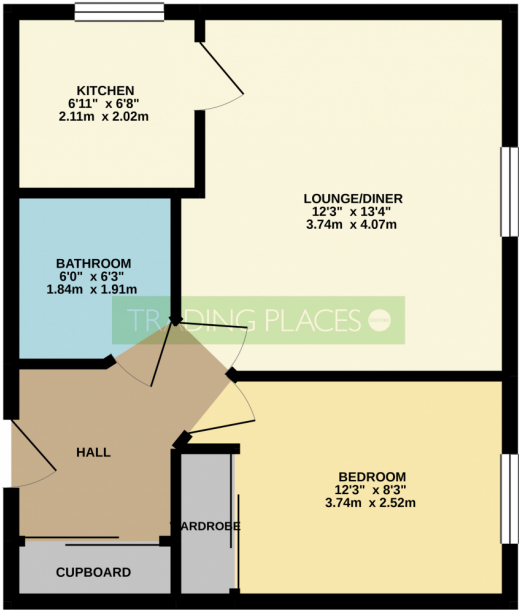

TOTAL FLOOR AREA: 395 sq.ft. (36.7 sq.m.) approx.
Whilst every attempt has been made to ensure the accuracy of the floorplan contained here, measurements of doors, windows, rooms and any other items are approximate and no responsibility is taken for any error, omission or mis-statement. This plan is for illustrative purposes only and should be used as such by any prospective purchaser. The services, systems and appliances shown have not been tested and no guarantee as to their quality or efficiency can be given.
Made with Metaplan (2021).

