



 **3**
Bedrooms

 **2**
Bathrooms





TRADING PLACES ESTATE AGENTS are delighted to offer for sale this stunning THREE BEDROOM/TWO BATHROOM end town house. The first one to come available since the phase sold out and this particular property has the BEST POSITION WITHIN THE COURTYARD DEVELOPMENT. Finished to an exceptional standard throughout this contemporary property is available to view and feature three spacious bedrooms, large windows, open plan family living, en-suite to the master bedroom and allocated parking for two cars. Good size garden to the front and rear. Ideally situated the development is located close to a wide range of amenities, restaurants and excellent transport links providing direct access into Salford Quays, MediaCityUK and Manchester City Centre.

GROUND FLOOR
319 sq.ft. (29.7 sq.m.) approx.

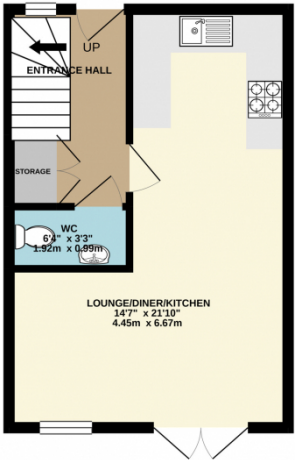

1ST FLOOR
319 sq.ft. (29.7 sq.m.) approx.

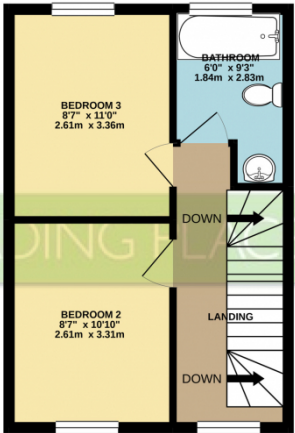

2ND FLOOR
281 sq.ft. (26.1 sq.m.) approx.

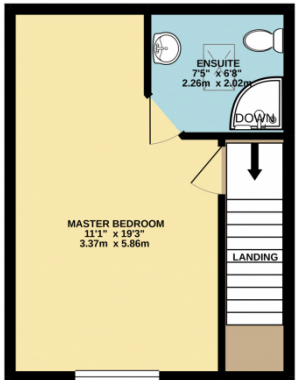

TOTAL FLOOR AREA : 919 sq.ft. (85.4 sq.m.) approx.

Whilst every attempt has been made to ensure the accuracy of the floorplan contained here, measurements of doors, windows, rooms and any other items are approximate and no responsibility is taken for any error, omission or mis-statement. This plan is for illustrative purposes only and should be used as such by any prospective purchaser. The services, systems and appliances shown have not been tested and no guarantee as to their operability or efficiency can be given.
Made with Metropix ©2021

