



 3
Bedrooms

 2
Bathrooms





Trading Places are proud to be welcoming to the market this unique home. The property is in a highly sought-after area of Stretford, in catchment for outstanding schools, close to transport links and local amenities.

The property briefly comprises of an entrance hall with a spiral stairway to the bathroom on the first floor, a spacious lounge with fireplace, kitchen diner with patio doors leading to the large rear garden, two double bedrooms the master benefiting from an ensuite. Additionally, the property has off road parking for multiple cars.

The property has an additional detached annex which has a private entrance, large lounge, double bedroom, ensuite bathroom and private garden.

Viewings are essential for this property, please call the office to arrange.

Hallway

UPVC Front Door, granite marble effect flooring, access to the main house and a staircase to the first floor.

Lounge

Granite marble effect flooring, bay UPVC window, gas fire and a double radiator.

Kitchen

Tiled flooring, sliding double glazed patio doors, range oven and gas hob, island with sink and mixer tap.

Master Bedroom

Laminate flooring, double glazed bay window, double radiator and fitted wardrobes.

Ensuite

Walk in shower, sink, W.C, dark granite flooring, frosted double glazed window and heated towel radiator.

Bedroom 2

Dark grey carpet, two double glazed windows, double glazed patio doors to the rear garden and fitted wardrobes.

Bathroom Ground Floor

Dark granite floor tiles, frosted double glazed windows, walk in shower, sink and a W.C

Bathroom First Floor

Double glazed window, free standing roll top bath and storage.

Rear Garden

Large enclosed rear garden, decking, patio, and grassed areas.

GROUND FLOOR

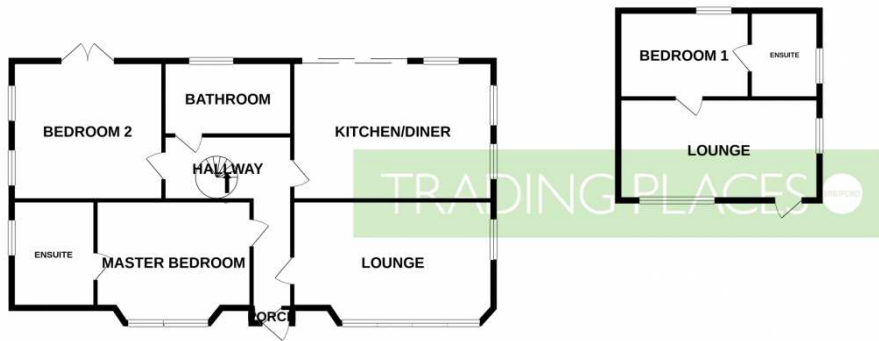

1ST FLOOR

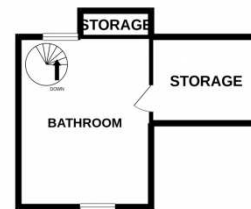

Whilst every attempt has been made to ensure the accuracy of the floorplan contained here, measurements of doors, windows, rooms and any other items are approximate and no responsibility is taken for any error, omission or mis-statement. This plan is for illustrative purposes only and should be used as such by any prospective purchaser. The services, systems and appliances shown have not been tested and no guarantee as to their operability or efficiency can be given.
Made with Metropix ©2021

