



 **2**  
Bedrooms

 **2**  
Bathrooms





We are delighted to offer for rent this modern two double bedroom apartment in the exclusive Beaufort Park development where residents benefit from a residents spa, swimming pool and use of the gymnasium. This particular property also has the huge added advantage of an a parking space within the secure underground car park.

This extremely spacious property benefits from a large kitchen/diner with modern integrated appliances and breakfast bar area. A bright and spacious reception room with a corner balcony. Wood flooring throughout except in the bedrooms which are carpeted. There is also a fully tiled family bathroom as well as an additional en-suite shower room from the main bedroom.

Offered unfurnished and available 19th June 2023.



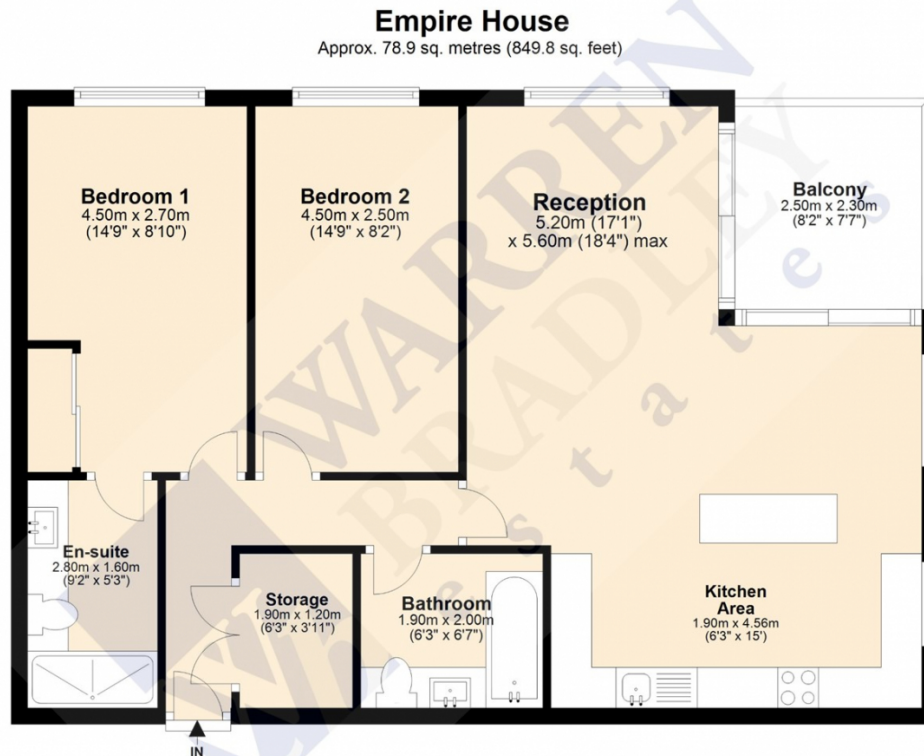

Total area: approx. 78.9 sq. metres (849.8 sq. feet)

Disclaimer: Please note this floor plan is for marketing purposes and is to be used as a guide only.  
Plan produced using PlanUp.

Score	Energy rating	Current	Potential
92+	A		
81-91	B		81   B
69-80	C	74   C	
55-68	D		
39-54	E		
21-38	F		
1-20	G		

The graph shows this property's current and potential energy efficiency.

