



 3

Bedrooms

 1

Bathroom



***** 360 DEGREE TOUR AVAILABLE *****

Warren Bradley Estates are pleased to offer for rent this 3 DOUBLE bedroom apartment located on the 4th Floor in the popular Beaufort Park Development. Offered in good condition the property has a large lounge with open plan kitchen, 3 double bedrooms, modern bathroom, seperate additional toilet and utility cupboard. Offered furnished. The property is near to local shops including Tesco's Express, multiple transport facilities including Colindale's Northern Line Underground Station. Secure parking is also available at a cost of £200pa. This property is available now

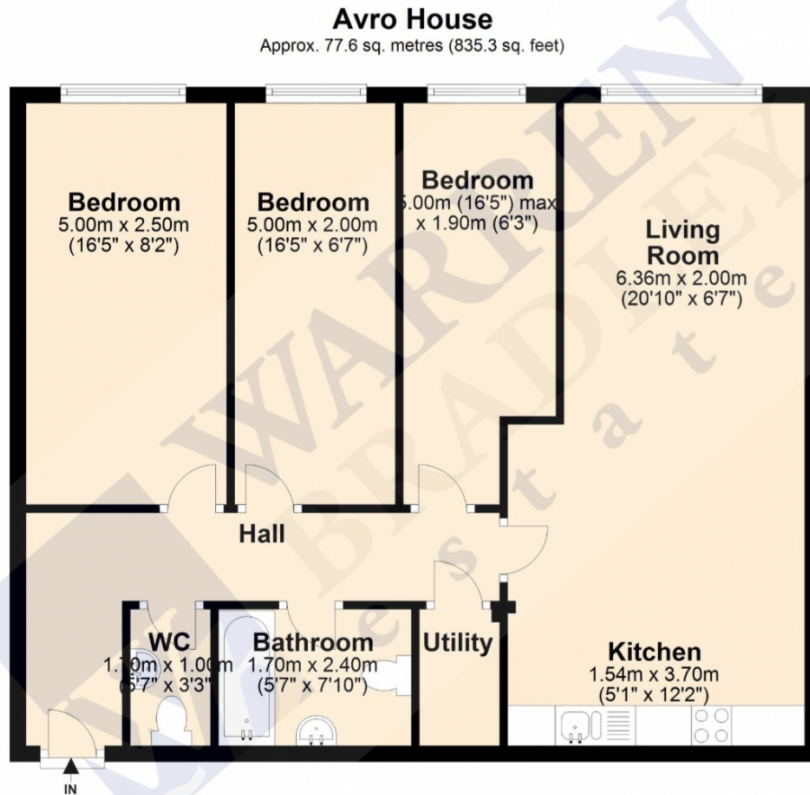

Total area: approx. 77.6 sq. metres (835.3 sq. feet)

